

**PLEASE CHECK WWW.MOLEX.COM FOR LATEST PART INFORMATION**

**Part Number:** [63445-2574](#)  
**Status:** **Active**  
**Description:** Conductor Anvil

**Documents:**  
[RoHS Certificate of Compliance \(PDF\)](#)

**General**

Product Family	Application Tooling
Series	<a href="#">T1118</a>
Comments	See Tooling Specification (PDF) Above
Function	Cutter
Geographic Area	Global
Level of Automation	Semi-Automatic
More Detailed Tech Information	<a href="mailto:applicationtooling@molex.com">applicationtooling@molex.com</a>
Product Name	N/A
Survey	<a href="http://www.molex.com//review/apptool_survey.html">www.molex.com//review/apptool_survey.html</a>
Tool Type	Anvil
UPC	822348134335

**Physical**

Net Weight 8.320/g

**Material Info**

**Reference - Drawing Numbers**

Application Tooling Documents [ATS-STANDARD-PARTS](#)

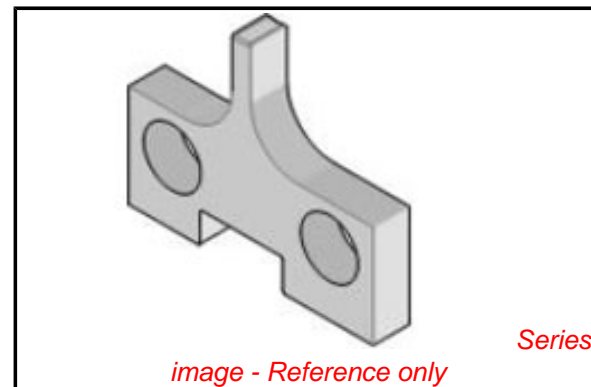

**EU RoHS**

**ELV and RoHS  
Compliant**

**REACH SVHC**

Not Reviewed

**Low-Halogen Status**

**Not Reviewed**

**China RoHS**



**Need more information on product  
environmental compliance?**

Email [productcompliance@molex.com](mailto:productcompliance@molex.com)  
 For a multiple part number RoHS Certificate of  
 Compliance, [click here](#)

Please visit the [Contact Us](#) section for any  
 non-product compliance questions.

**Search Parts in this Series**

[T1118Series](#)

**Use With**

[63867-8000](#) , [63867-8070](#) , [63867-8100](#) ,  
[63867-8170](#) , [63867-8200](#) , [63867-8270](#) ,  
[63900-0200](#) , [63900-0270](#) , [63900-0700](#) ,  
[63900-0770](#)

**PLEASE CHECK WWW.MOLEX.COM FOR LATEST PART INFORMATION**