

THIS DRAWING IS UNPUBLISHED. RELEASED FOR PUBLICATION, 19 .
 (C) COPYRIGHT 19 BY AMP INCORPORATED. ALL RIGHTS RESERVED.

LOC	DIST	REVISIONS			
P	LTR	DESCRIPTION	DATE	DWN	APVD
CM	53	B	REV PER EC 0L30-0233-97	12-9-97	JH RS

- ① USED IN AMP-DUAC/PL™ PLUG RECEPTACLE HOUSINGS FOR SECONDARY LOCKING OF THE SOCKET CONTACTS.
- 2. ONE PL USED PER HOUSING; MAY BE INSTALLED FROM EITHER SIDE.
- ③ PL AND PLUG HOUSING AVAILABLE AS A BULK KIT.

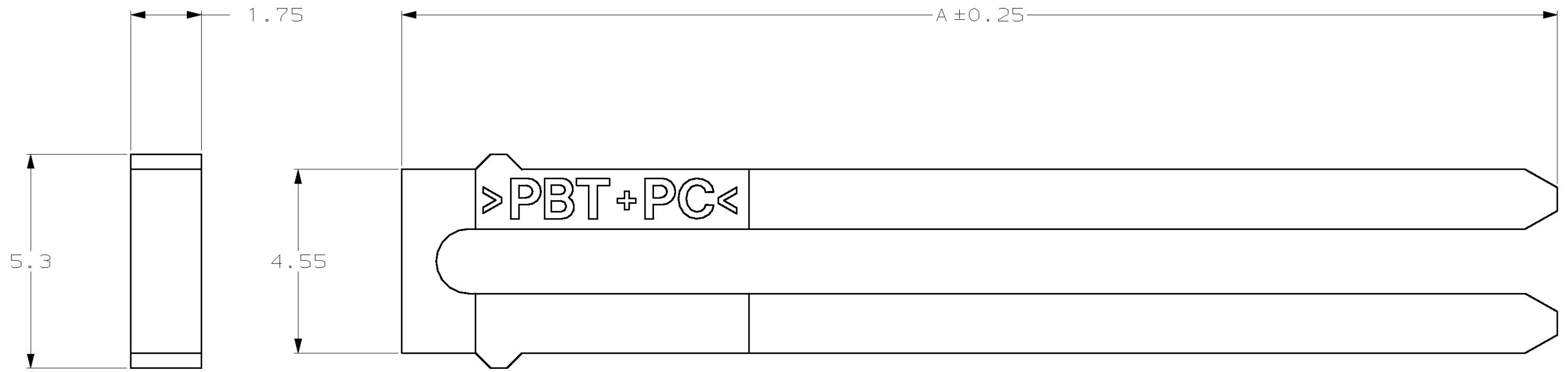

794322-1	794156-1	12	28.65	794145-6
794319-1	794153-1	6	16.10	794145-3
794318-1	794152-1	4	11.85	794145-2
BULK KIT ③	PLUG ①	CKT SIZE (REF)	DIM A	PART NUMBER

METRIC

THIS DRAWING IS A CONTROLLED DOCUMENT.

DIMENSIONS: mm	TOLERANCES UNLESS OTHERWISE SPECIFIED:	DWN K. WHITAKER 8-08-97	AMP AMP Incorporated Harrisburg, PA 17105-3608
	0 PLC ±-	CHK R. SWING 8-08-97	
	1 PLC ±0.2	APVD E. BEILES 8-08-97	
MATERIAL PBT, JL 94V-0, NATURAL	FINISH -	PRODUCT SPEC 108-1646	NAME POSITION LOCK, AMP-DUAC/PL™ POWER CONNECTOR
		APPLICATION SPEC 114-6067	SIZE CAGE CODE DRAWING NO RESTRICTED TO
		WEIGHT -	A3 00779 C-794145
		CUSTOMER DRAWING	SCALE 10:1 SHEET 1 OF 1 REV B