

THIS DRAWING IS UNPUBLISHED. RELEASED FOR PUBLICATION ,19 .  
 © COPYRIGHT 19 BY AMP INCORPORATED. ALL INTERNATIONAL RIGHTS RESERVED.

LOC	DIST	P	F	ZONE	LTR	DESCRIPTION	DATE	APPD
G	14				C	REV PER 0G3A-0001-03	07JAN03	JR TM

**AMP**  
 WIRE RANGE  
 16-14 AWG  
 SOLID OR STRANDED

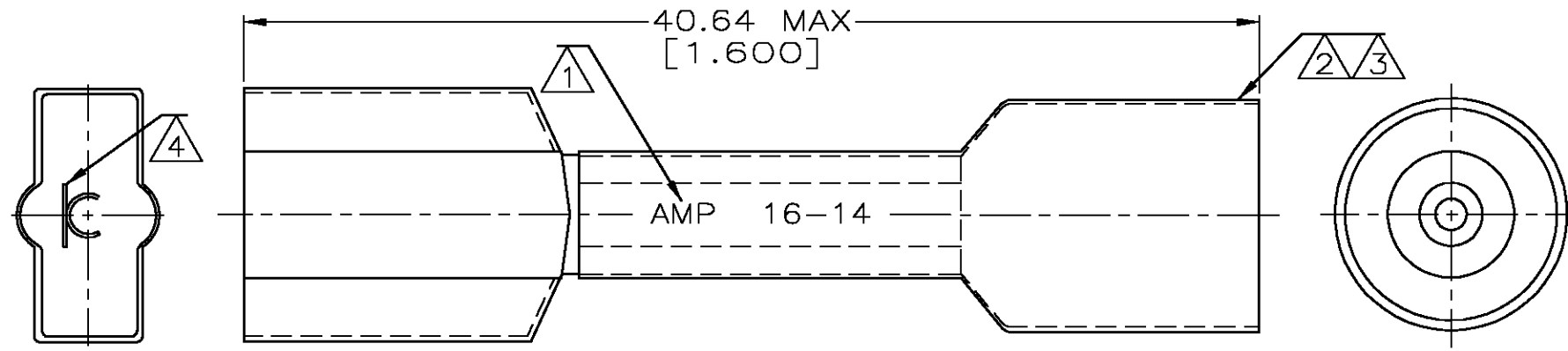

- NOTES:
- ① STAMP AMP 16-14 APPROX AS SHOWN
  - ② SEALANT THROUGHOUT SHRINKABLE INSULATION
  - ③ HEAT SHRINKABLE TUBING MAY BE IRREGULAR IN SHAPE
  - ④ TAB FOR 6.35 X 0.81mm [.250 X .032] SERIES FASTON RECEPTACLE

**AMP INCORPORATED**  
**CUSTOMER SERVICE SYSTEMS**

FOR ADDITIONAL PRODUCT INFORMATION OR COPIES OF DRAWINGS AND TECHNICAL DOCUMENTS	PRODUCT INFORMATION CENTER 1-800-522-6752
FOR APPLICATION TOOLING INFORMATION	TOOLING ASSISTANCE CENTER 1-800-722-1111
FOR ORDER ENTRY	1-800-526-5142

MAX RECOMMENDED OPERATING TEMPERATURE:  
 -55° C TO 125° C

VOLTAGE RATING:  
 600V MAX (BUILDING WIRING)  
 1000V MAX (FIXTURES & SIGNS)

CIRCULAR MIL AREA:  
 1.04-2.62mm<sup>2</sup> [2050-5180]

THIS DRAWING IS A CONTROLLED DOCUMENT FOR AMP INCORPORATED. IT IS SUBJECT TO CHANGE AND THE CONTROLLING ENGINEERING ORGANIZATION SHOULD BE CONTACTED FOR THE LATEST REVISION.

DO NOT SCALE PRINT. UNLESS SPECIFIED DIMENSIONS IN mm [INCHES] TOLERANCES ON:  
 2 PLC DEC ± 0.20[.008]  
 3 PLC DEC ± -  
 ANGLES ± -

MATERIAL  
 BODY: ETP COPPER  
 INSULATION: POLYOLEFIN TRANSLUCENT  
 COLOR: NYLON BLUE

FINISH  
 EDP TIN PLATED

25	LOOSE PIECE	8-55888-3
1000	LOOSE PIECE	55888-1
QTY	PACKAGE TYPE	PART NO
DR 6/93 S S GOULDEN	<b>AMP</b> AMP Incorporated Harrisburg, PA 17105-3608	
CHK 6/93 R HERSEY	NAME	
APPD 6/93 B BARE	PRE-INSULATED FASTON TAB ASSEMBLY 250 SERIES, HEAT SHRINKABLE SEALABLE SLEEVE	
APPD 6/93 M ELLIS	SIZE	CAGE CODE
PRODUCT SPEC	<b>B</b>	00779
APPLICATION SPEC	SCALE	DRAWING NO
WEIGHT -	4:1	<b>C-55888</b>
		SHEET 1 OF 1