

Base strip - IPC 16/ 3-GFU-10,16 - 1969946

Please be informed that the data shown in this PDF Document is generated from our Online Catalog. Please find the complete data in the user's documentation. Our General Terms of Use for Downloads are valid (<http://phoenixcontact.com/download>)

Header, Nominal current: 76 A, Rated voltage (III/2): 1000 V, Number of positions: 3, Pitch: 10.16 mm, Color: green, Contact surface: Silver, Assembly: Soldering, Plug direction parallel to the PCB: connector part rotated by 180° with respect to the plug axis.



The figure shows a 5-pos. version of the product

Product Features

- Inverted IPC 16 headers for implementing a touch-proof PCB output or a PCB/PCB connection (in combination with PC 6-16 base strips)
- PCB-SHIELD shroud (EMC connection)



Key commercial data

| | |
|--------------------------------------|---|
| Packing unit | 1 pc |
| Minimum order quantity | 50 pc |
| GTIN |  4 017918 948696 |
| Weight per Piece (excluding packing) | 15.69 GRM |
| Custom tariff number | 85366990 |
| Country of origin | Poland |

Technical data

Dimensions

| | |
|----------------|-----------|
| Length | 32.1 mm |
| Pitch | 10.16 mm |
| Dimension a | 20.32 mm |
| Pin dimensions | 0,8 x 1,2 |
| Pin spacing | 10.16 mm |
| Hole diameter | 1.7 mm |

General

Base strip - IPC 16/ 3-GFU-10,16 - 1969946

Technical data

General

| | |
|---|---------------|
| Range of articles | IPC 16/...GFU |
| Insulating material group | I |
| Rated surge voltage (III/3) | 8 kV |
| Rated surge voltage (III/2) | 8 kV |
| Rated surge voltage (II/2) | 8 kV |
| Rated voltage (III/3) | 1000 V |
| Rated voltage (III/2) | 1000 V |
| Rated voltage (II/2) | 1000 V |
| Nominal current I_N | 76 A |
| Maximum load current | 76 A |
| Insulating material | PA |
| Inflammability class according to UL 94 | V0 |
| Color | green |
| Number of positions | 3 |

Classifications

eCl@ss

| | |
|------------|----------|
| eCl@ss 4.0 | 272607xx |
| eCl@ss 4.1 | 27260701 |
| eCl@ss 5.0 | 27260701 |
| eCl@ss 5.1 | 27260701 |
| eCl@ss 6.0 | 27260704 |
| eCl@ss 7.0 | 27440402 |
| eCl@ss 8.0 | 27440402 |

ETIM

| | |
|----------|----------|
| ETIM 3.0 | EC001121 |
| ETIM 4.0 | EC002637 |
| ETIM 5.0 | EC002637 |

UNSPSC

| | |
|---------------|----------|
| UNSPSC 6.01 | 30211810 |
| UNSPSC 7.0901 | 39121409 |
| UNSPSC 11 | 39121409 |
| UNSPSC 12.01 | 39121409 |
| UNSPSC 13.2 | 39121409 |

Base strip - IPC 16/ 3-GFU-10,16 - 1969946

Approvals

Approvals

Approvals

UL Recognized / SEV / cUL Recognized / CCA / GOST / GOST / cULus Recognized

Ex Approvals

Approvals submitted

Approval details

| | | | |
|--|-------|-------|-------|
| UL Recognized  | | | |
| | B | C | D |
| Nominal current IN | 66 A | 66 A | 5 A |
| Nominal voltage UN | 300 V | 300 V | 600 V |

| | |
|--------------------|--------|
| SEV | |
| | |
| Nominal current IN | 76 A |
| Nominal voltage UN | 1000 V |

| | | | |
|--|-------|-------|-------|
| cUL Recognized  | | | |
| | B | C | D |
| Nominal current IN | 66 A | 66 A | 5 A |
| Nominal voltage UN | 300 V | 300 V | 600 V |

| | |
|--------------------|--------|
| CCA | |
| | |
| Nominal current IN | 76 A |
| Nominal voltage UN | 1000 V |

Base strip - IPC 16/ 3-GFU-10,16 - 1969946

Approvals



Drawings

Drilling diagram

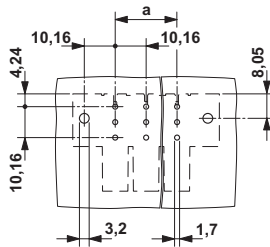

Dimensioned drawing

