

RECOMMENDED PCB LAYOUT
PCB THICKNESS : 1.6mm

mot'l. code	tolerances unless otherwise specified	CUSTOMER COPY	title	code
l/r	.X ± 0.38	projection	MICRO S-ATA RECEP	TWN
A	.XX ± 0.25	scale	R/A, DIP TYPE	sheet
B	.XXX ± 0.15	MM	product family SAT A	1 of 1
dr		angles	eng/STERLING LIN/04/16/08	
chr		oppd	STERLING LIN/04/16/08	
index		sheet	MINERVA WANG/04/16/08	
sheet		revision		
index		sheet		

mot'l. code	ecn no	dr	dtte	linear	angles	projection	title	code
A	108-1073S.Lin	04/16/08	10/01/08	.XXX ± 0.15	0° ± 2°	MM	MICRO S-ATA RECEP	TWN
B	108-1167S.Lin	10/01/08				NA	R/A, DIP TYPE	sheet
sheet		revision					product family SAT A	1 of 1
index		sheet					10080211	

mot'l. code	ecn no	dr	dtte	linear	angles	projection	title	code
A	108-1073S.Lin	04/16/08	10/01/08	.XXX ± 0.15	0° ± 2°	MM	MICRO S-ATA RECEP	TWN
B	108-1167S.Lin	10/01/08				NA	R/A, DIP TYPE	sheet
sheet		revision					product family SAT A	1 of 1
index		sheet					10080211	

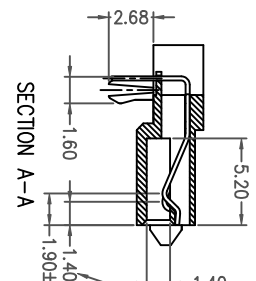

- NOTES:
- MATERIAL
 - 1) HOUSING : HIGH TEMP THERMOPLASTIC UL94V-0 (COLOR:BLACK)
 - 2) TERMINAL : COPPER ALLOY
 - 3) HOLD DOWN : COPPER ALLOY
 - FINISH
 - 1) TERMINAL : Au PLATING (CONTACT POINT) OVER 50u" NICKEL
 - 2) SOLDER TAIL : 50u" min MATT TIN OVER 50u" NICKEL
 - 3) THE HOUSING WILL WITHSTAND EXPOSURE TO 260C FOR 10 SEC.
 - IN A WAVE SOLDER APPLICATION WITH A 1.6MM PCB
 - PRODUCT SPEC: GS-12-494
 - PACKING SPEC: GS-14-1283
 - PRODUCT NUMBERING
 - 10080211 - X 0 0 X LE

- 0: 5u" Au PLATING
- 1: G/F Au PLATING
- 2: 15u" Au PLATING
- 3: 30u" Au PLATING
- LEAD FREE
- TRAY PACKING