

NOTES: (b)

1. RoHS COMPLIANT
2. FOR WAVESOLDERING (SOLDER BATH TEMPERATURE 260°C FOR 5 SEC. AND SOLDER PREHEAT 100°C FOR 30 SEC.)
3. METALSHELLS: STEEL; min. 315µin TIN over 40-80µin NICKEL
4. INSULATOR: HIGH TEMPERATURE PLASTIC UL 94 V-0; BLACK
5. CONTACTS: COPPER ALLOY
PLATING: GOLD FLASH over NICKEL
6. METAL BRACKETS: ZINC DIE CAST;
300µin COPPER / 40-120µin NICKEL / 120-200µin TIN
7. THREADED INSERTS: COPPER ALLOY;
min. 200µin TIN over 80µin NICKEL
8. PCB-SNAPS: COPPER ALLOY; min. 200µin TIN over 80µin NICKEL
PCB-HOLE: $\varnothing 3,1 \pm 0,1$; PCB THICKNESS 1,6mm
9. FIXING-PLATE: PBT GF UL 94 V-0; BLACK
10. P.C.B. HOLE DRILLINGS ON SHEET 2
11. CAPACITANCE: 370pF $\pm 20\%$
12. DIELECTRIC WITHSTANDING VOLTAGE: 300 VDC
13. MAXIMUM TORQUE VALUE FOR THREAD: 6 in. LB
14. CONNECTOR IS PART MARKED: 242A25810X CONEC ABC

(5:1)

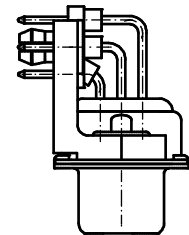
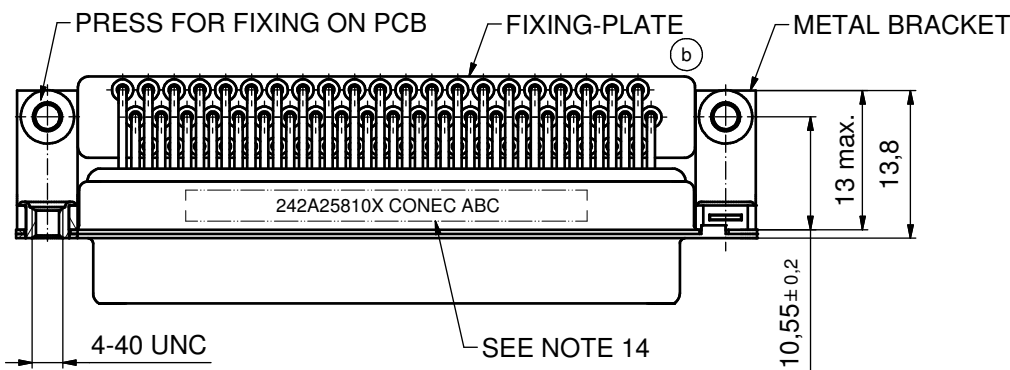
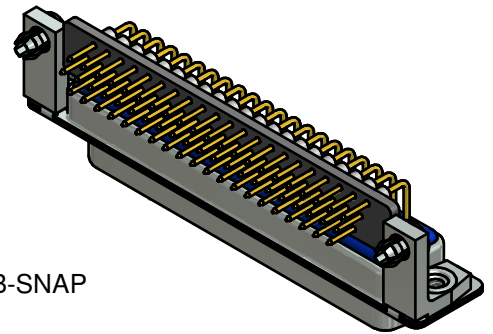
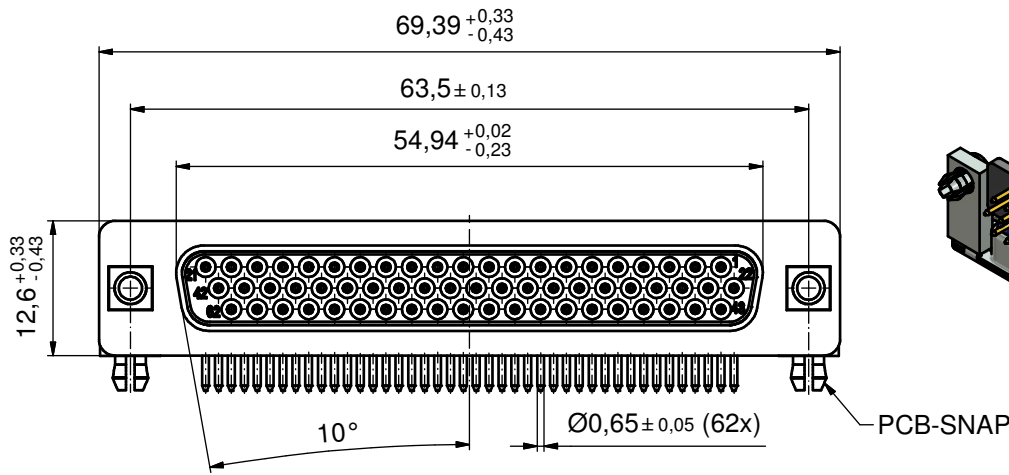
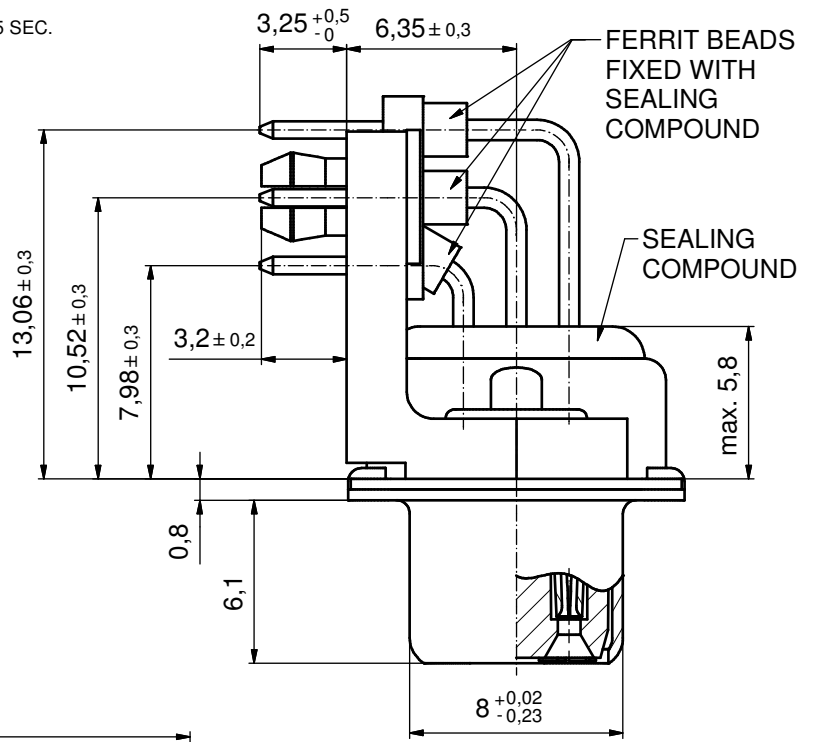

Directive 2002/95/EC RoHS compliant

THIS DRAWING MAY NOT BE COPIED OR REPRODUCED IN ANY WAY, AND MAY NOT BE PASSED ON TO A THIRD PARTY WITHOUT WRITTEN PERMISSION. OWNERSHIP AND COPYRIGHT OF CONEC GmbH DO NOT ALTER CAD DRAWING BY HAND	tolerance		ISO 2768-m		dim. in mm		scale:	2:1 (5:1)			
								material:	SEE NOTES		
								title:	D-SUB HD FILTER FEMALE 90°		
								62pos. 0.314inch		with threaded insert, metal bracket and clip	
								dwg no:	24K1A243		
								part no:	242A25810X		
2 x b	Ä4216	02.02.2012	K.H.	CONEC®		DIN-A3		sh: 1			
rev.	description	date	name								

P.C.B. HOLE DRILLINGS
(P.C.B. TOP SIDE)

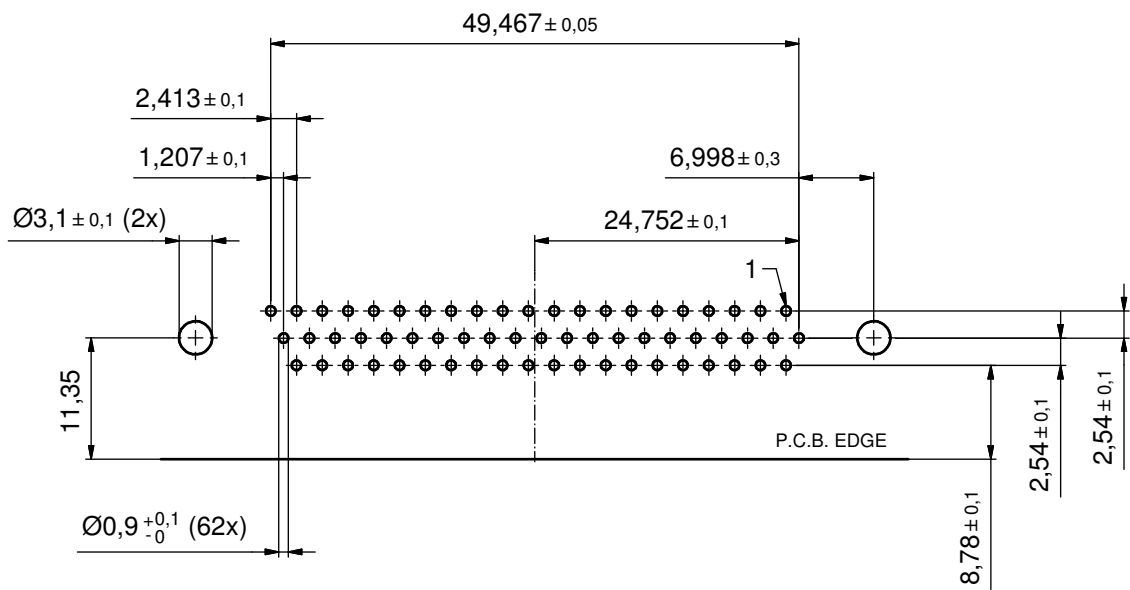

THIS DRAWING MAY NOT BE COPIED OR REPRODUCED IN ANY WAY, AND MAY NOT BE PASSED ON TO A THIRD PARTY WITHOUT WRITTEN PERMISSION. OWNERSHIP AND COPYRIGHT OF CONEC GmbH DO NOT ALTER CAD DRAWING BY HAND					tolerance ISO 2768-m		scale: 2:1
					date	name	material: SEE SHEET 1
					drawn	15.04.02	Parei
					appd.	15.04.02	Mickenbecker
					norm		
				d-old			
2 x b	Ä4216	02.02.2012	K.H.				title: P.C.B. HOLE DRILLINGS D-SUB HD FILTER FEMALE 90°, 62pos. thread insert, metal bracket, fixing-plate, ferrit bead
a	Original						dwg no: 24K1A243
rev.	description	date	name				part no: SEE SHEET 1