

8 | 7 | 6 | 5 | 4 | 3 | 2 | 1

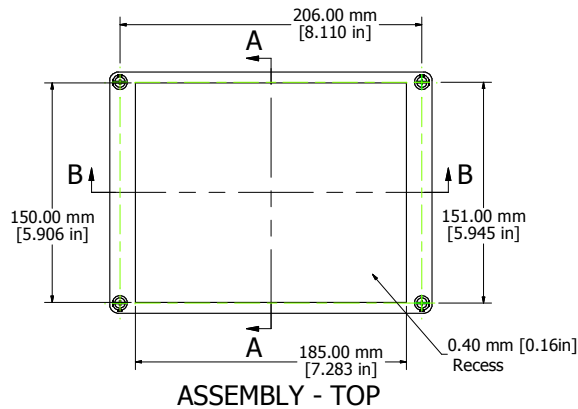

ASSEMBLY - TOP

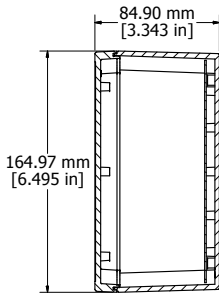

SECTION A-A

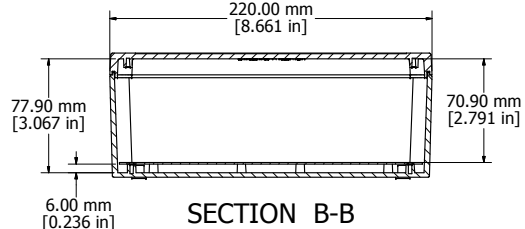
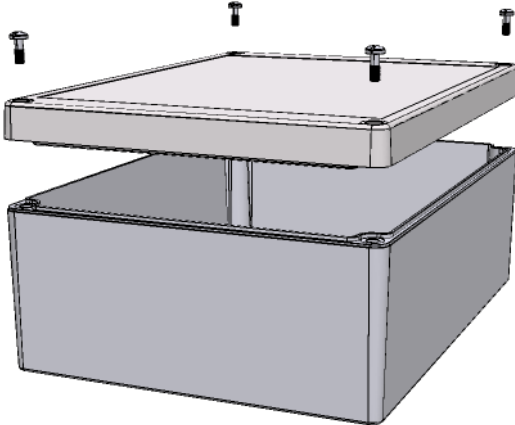

SECTION B-B

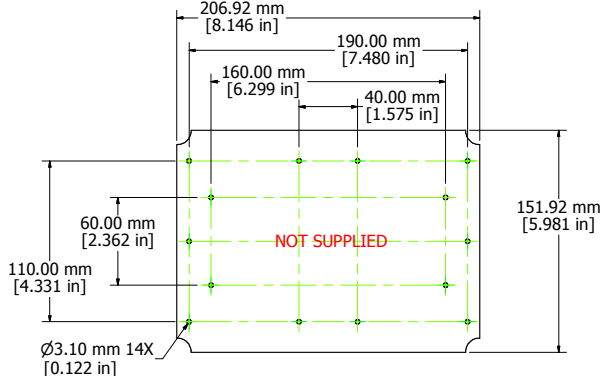

INNER PANEL

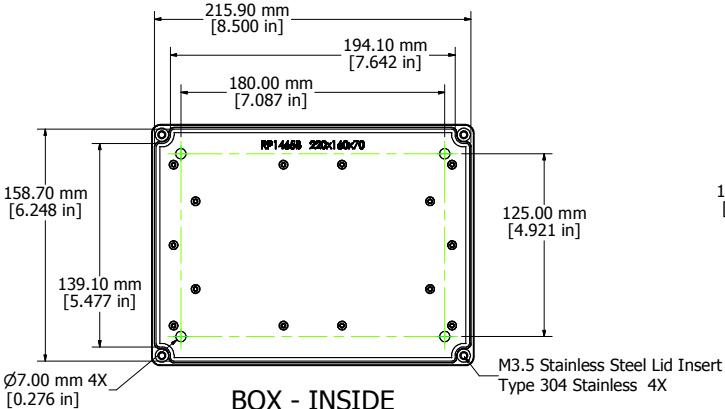

BOX - INSIDE

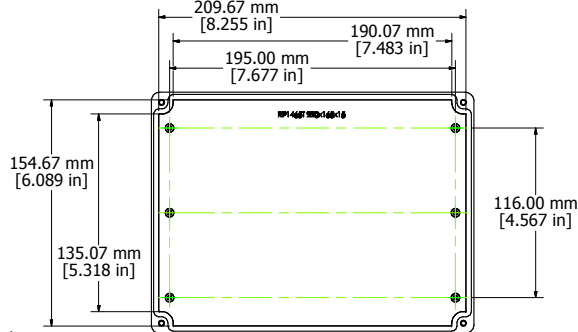

LID - INSIDE

Enclosures can be Factory Modified (Milling, Drilling, Printing etc.)
 Contact Factory mjm@hammondmfg.com for quotes
 Solid models of this enclosure available in STEP or IGES.

RP1465
Material: ABS (UL94-HB), Light Gray Color
Lid Screws: M3.5 x 10, 304 Stainless
Gasket: EDPM Cord.
Circuit Board Screws, 4 Supplied (M3 self tap)
Suggested Lid Screw Torque: 30ozf-in (21cN-m)



**HAMMOND
 MANUFACTURING™**

RP1465

www.hammondmfg.com

8 | 7 | 6 | 5 | 4 | 3 | 2 | 1