

THIS IS A C.A.D. GENERATED DRAWING  
DO NOT MAKE MANUAL REVISIONS TO MASTER.

TOLERANCE UNLESS OTHERWISE SPECIFIED IN MM:	ANGLE
0	3°
0.0	
0.00	
0.000	

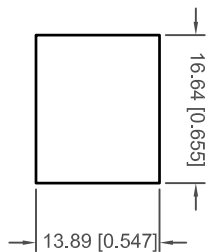

RECOMMENDED  
PANEL CUTOUT DIMENSION

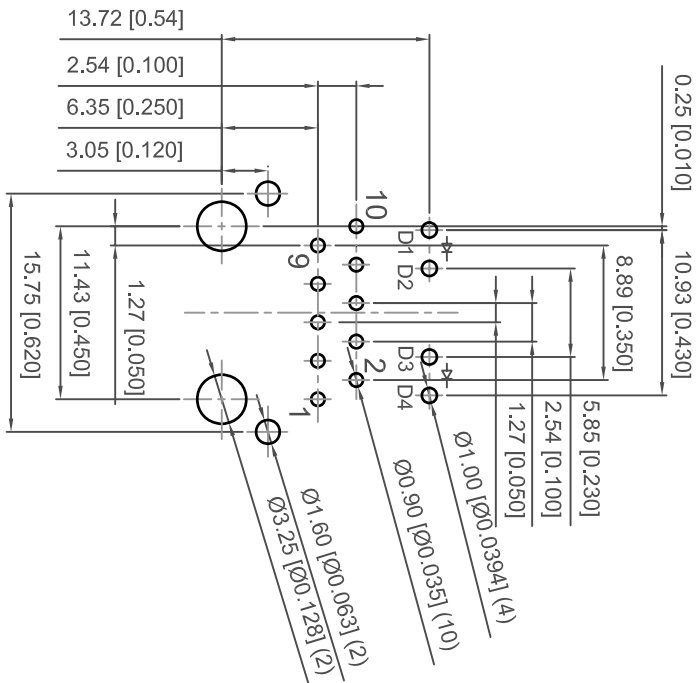
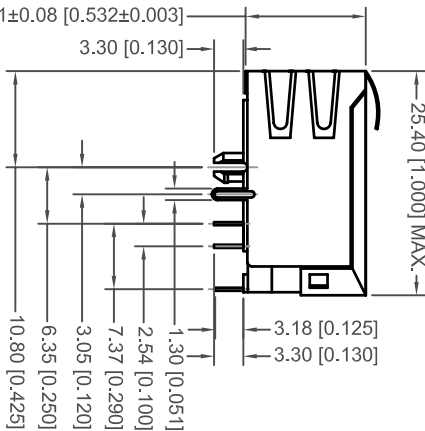
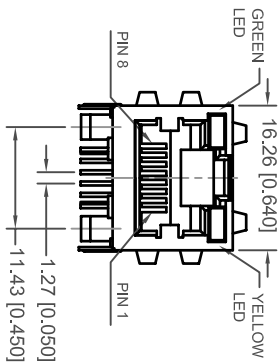
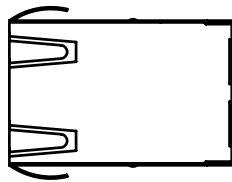

RECOMMENDED P.C.B. LAYOUT  
TOLERANCE: ±0.05[±0.002]

- NOTES:
- MATERIALS:  
HOUSING: NYLON POLYESTER WITH GLASS FIBER, UL94 V-0, COLOR: BLACK  
CONTACTS: 0.35MM PHOSPHOR BRONZE PLATED WITH GOLD PLATING AND TIN IN SOLDER AREA
- |                 |                         |
|-----------------|-------------------------|
| PART NO         | GOLD PLATING THICKNESS  |
| A60-112-231N432 | GOLD FLASH PLATING      |
| A60-113-231N432 | 15 MICRO INCHES OF GOLD |
| A60-114-231N432 | 30 MICRO INCHES OF GOLD |
- SHIELD: 0.20MM COPPER ALLOY WITH NICKEL PLATING
- OPERATING TEMPERATURE: 0°C TO +70°C
  - MATE WITH MODULAR PLUG CONFORMING TO FCC PART 68, SUBPART F.
  - DIMENSION: MM [INCHES]



THIS SERIES FULLY CONFORMS TO THE  
EUROPEAN UNION DIRECTIVES 2002/95/EC  
AND 2002/96/EC FOR RoHS COMPLIANCY.

**RJ45 MAGNETIC JACK WITH LED, 10P, 8C  
SHIELDED, 10/100/1000 Mbps FILTER**

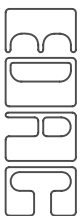

EDAC INC  
TORONTO, ONTARIO  
CANADA

YOUR CONNECTION TO QUALITY & SERVICE

THESE DRAWINGS AND SPECIFICATIONS  
ARE THE PROPERTY OF EDAC INC. AND  
SHALL NOT BE REPRODUCED OR COPIED  
OR USED AS THE BASIS FOR THE  
MANUFACTURE OR SALE OF APPARATUS  
WITHOUT WRITTEN PERMISSION.

ACAD REFERENCE NO.: A60-112-231N432

DRAWN: R.STA.MONICA DATE: JAN.24/2011

CHECKED: DATE:

PART NUMBER

SEE NOTE

SHEET 1 OF 2

DRAWING NUMBER

A60-112-231N432

ISSUE

1

**ELECTRICAL CIRCUIT:**

CONNECTOR SOLDER SIDE

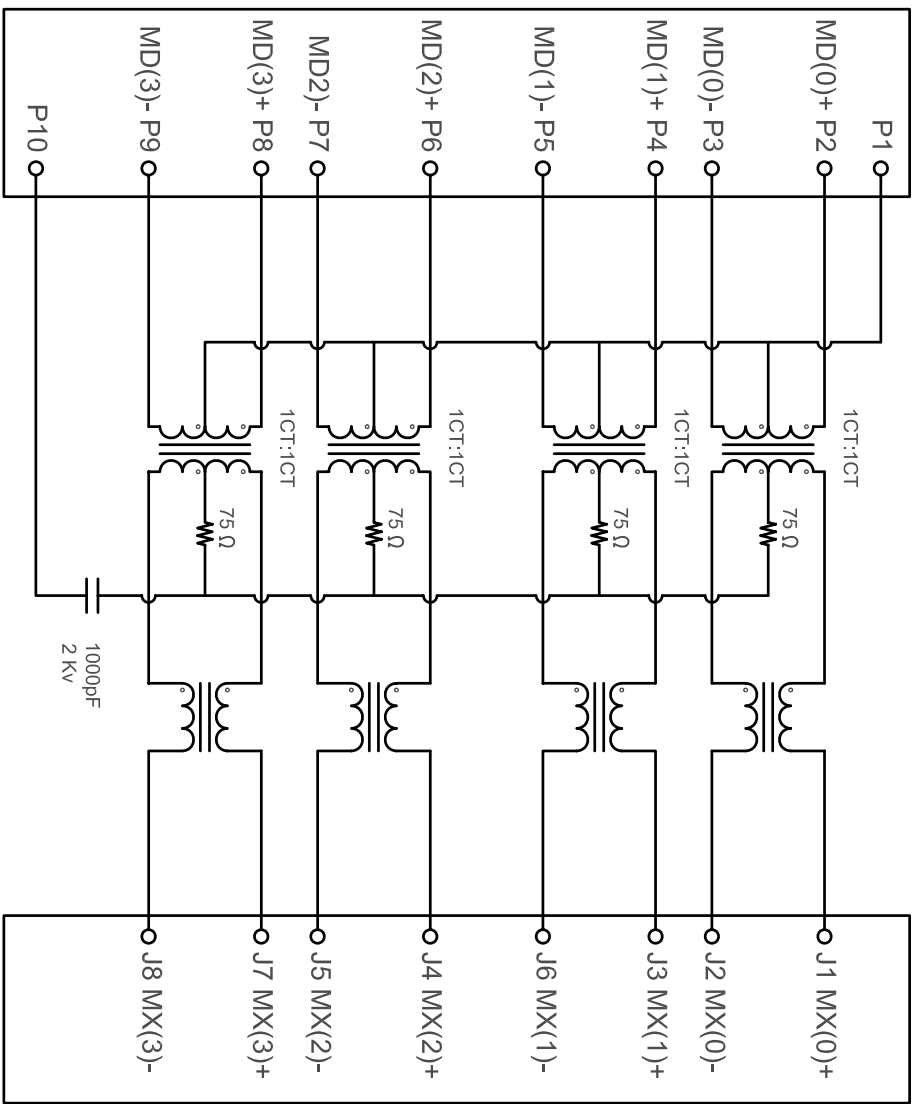

RJ45 CONTACT SIDE

TOLERANCE UNLESS OTHERWISE SPECIFIED IN MM:	ANGLE	3°
0	± 0.50	
0.0	± 0.38	
0.00	± 0.25	
0.000	± 0.10	

THIS IS A C.A.D. GENERATED DRAWING  
DO NOT MAKE MANUAL REVISIONS TO MASTER.

**TEST NOTES:(25±5°C)**

1. TR:(100KHz,0.1V); 100%  
PINS:(P2,P3):(J1,J2)=1:1±3%;(P4,P5):(J3,J6)=1:1±3%  
PINS:(P6,P7):(J4,J5)=1:1±3%;(P8,P9):(J7,J8)=1:1±3%
2. LX:(100KHz,100mV,8mA, DC Bias) 100%  
PINS:(P2,P3),(P4,P5),(P6,P7),(P8,P9)=350uH MINIMUM
3. DCR: 100%  
PINS:(J1,J2),(J3,J6),(J4,J5),(J7,J8)=1.0Ω MAXIMUM
4. HIPOT: 100%  
PINS:(P2,P3)TO(J1,J2),(P4,P5)TO(J3,J6)=1500VAC FOR 2 SECONDS  
PINS:(P6,P7)TO(J4,J5),(P8,P9)TO(J7,J8)=1500VAC FOR 2 SECONDS
5. INSERTION LOSS:  
-1dB MAXIMUM AT 1MHZ TO 100MHZ;
6. RETURN LOSS:  
-18dB MINIMUM AT 1MHZ TO30MHZ;  
-16dB MINIMUM AT 30MHZ TO 60MHZ  
-12dB MINIMUM AT 60MHZ TO 80MHZ
7. CROSS TALK:  
-35dB MINIMUM AT 1MHZ TO 100MHZ
8. COMMON TO COMMON MODE REJECTION:  
-30dB MINIMUM AT 1MHZ TO 100MHZ

**LED CIRCUIT:**

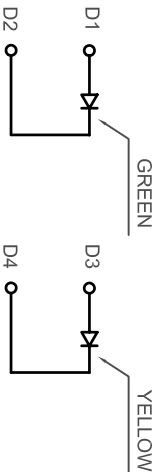

ISSUE NUMBER  
ORIGINAL

1

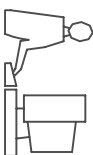

ISSUE NUMBER  
ORIGINAL

1

**RJ45 MAGNETIC JACK WITH LED, 10P, 8C  
SHIELDED, 10/100/1000 Mbps FILTER**

ACAD REFERENCE NO.: A60-112-231N432

DRAWN: R.STA.MONICA DATE: JAN.24/2011

CHECKED: DATE:

PART NUMBER

SEE NOTE

SHEET 2 OF 2

DRAWING NUMBER

A60-112-231N432

ISSUE

1



THIS SERIES FULLY CONFORMS TO THE  
EUROPEAN UNION DIRECTIVES 2002/95/EC  
AND 2002/96/EC FOR ROHS COMPLIANCY.

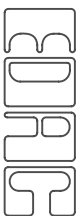

EDAC INC  
TORONTO, ONTARIO  
CANADA

YOUR CONNECTION TO QUALITY & SERVICE

THESE DRAWINGS AND SPECIFICATIONS  
ARE THE PROPERTY OF EDAC INC. AND  
SHALL NOT BE REPRODUCED OR COPIED  
OR USED AS THE BASIS FOR THE  
MANUFACTURE OR SALE OF APPARATUS  
WITHOUT WRITTEN PERMISSION.

Color	Lens Color	Vf(v) @20mA		Iv(mcd) @10mA		Viewing angle
		Min	Max	Min	Typ	
Yellow	Yellow Diffused	1.7	2.8	3.0	6.0	116
Green	Green Diffused	1.7	2.8	3.5	6.0	116