

THIS IS A C.A.D. GENERATED DRAWING
DO NOT MAKE MANUAL REVISIONS TO MASTER.

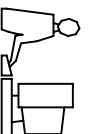

ISSUE NUMBER
ORIGINAL ①

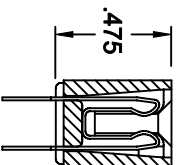
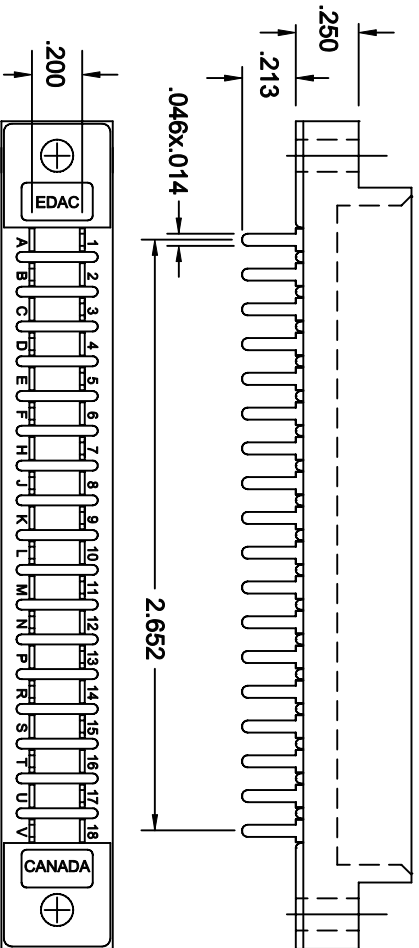
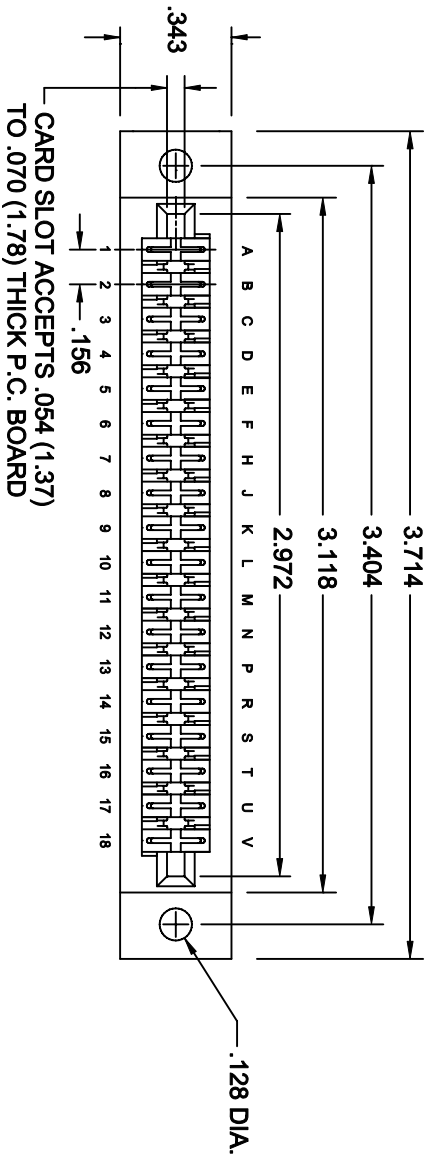

NOTES:

- 1) INSULATOR MATERIAL: THERMOPLASTIC POLYESTER, GLASS REINFORCED, FLAME RESISTANT UL94V-0 COLOUR- GREEN
- 2) CONTACT MATERIAL: PHOSPHOR BRONZE PER QQ-B-750, COMPOSITION A.
- 3) CONTACT PLATING: GOLD OVER NICKEL FOR ENTIRE CONTACT SURFACE.
- 4) CURRENT RATING: 5 AMPERES, CONTINUOUS
- 5) CONTACT RESISTANCE: 10 MILLIOHMS MAX.
- 6) OPERATING TEMPERATURE: -65°C TO +105°C
- 7) 381 - VARIATION 02 - CONTACTS STAGGERED 1,B,3,D, ETC.



THIS SERIES FULLY CONFORMS TO THE
EUROPEAN UNION DIRECTIVES 2002/95/EC
AND 2002/96/EC FOR ROHS COMPLIANCY.

307 CARD EDGE CONNECTOR



EDAC INC.
TORONTO, ONTARIO
CANADA

YOUR CONNECTION TO QUALITY & SERVICE

THESE DRAWINGS AND SPECIFICATIONS
ARE THE PROPERTY OF EDAC INC. AND
SHALL NOT BE REPRODUCED, OR COPIED
OR USED AS THE BASIS FOR THE
MANUFACTURE OR SALE OF APPARATUS
WITHOUT WRITTEN PERMISSION.

ACAD REFERENCE NO. 307-018-521-381

DRAWN: JLEE DATE: JUNE 18, 2009

PART NUMBER

307-018-521-381

DRAWING NUMBER

307-018-521-381

ISSUE

1