

complete length when assembled app. 42 mm

assembly aid enclosed

width across flat 18

M16x1,5

width across flat 19

width across flat 15

A (2:1)

contact face acc. to IEC 61076-2-101

panel thickness

Panel cut out (1:1)

min.2 - max.5

$\varnothing 16,3 \pm 0,2$

14,3 ± 0,2

- recommended torque of counter nut: 2Nm  
- order contacts separately

| cable $\varnothing$ |             |             | wire gauge | part-no.       |
|---------------------|-------------|-------------|------------|----------------|
| 5,7 - 6,9mm         | 6,5 - 7,7mm | 7,5 - 8,8mm |            |                |
| sealing             |             |             | AWG 26-22  | 09 67 000 5476 |
| A                   | B           | C           | AWG 24-20  | 09 67 000 8476 |
|                     |             |             | AWG 22-18  | 09 67 000 3476 |

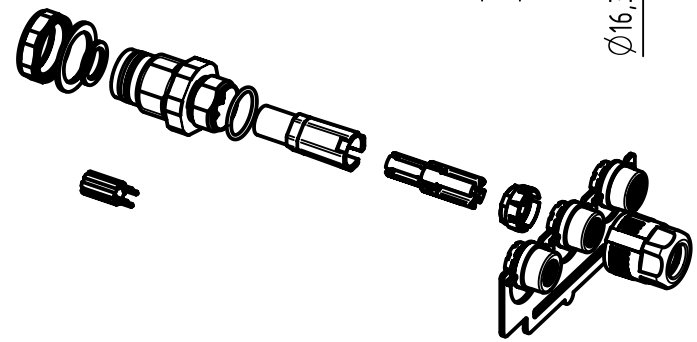

|   |  |                       |                             |                    |  |
|---|--|-----------------------|-----------------------------|--------------------|--|
| All Dimensions in mm<br>Original Size DIN A4  |  | Scale<br>1:1          | Free size tol.              |                    | Ref.   |
| All rights reserved<br>Department EC PD - RO  | Created by<br>POPESCUD                           | Inspected by<br>AVRAM | Standardisation<br>HOFFMANN | Date<br>2017-07-06 | State<br>Final Release                                   |
|   | Title<br>M12 PFT Crimp SD Female 4+5pole A-coded |                       |                             |                    | Doc-Key / ECM-Nr.<br>100707625/UGD/001/B<br>500000121871 |
| HARTING Electronics GmbH<br>D-32339 Espelkamp |  | Type<br>TB            | Number<br>21038212525       |                    | Rev. B<br>Page 1/1                                       |