

LOC		DIST		REVISIONS			
REV	DATE	BY	CHK	DESCRIPTION	DATE	DMN	APVD
AD	39	F1		ECO-05-11839	25JAN06	MB	JO
		F2		REVISED PER ECO-09-021826	21SEP09	KK	AEG

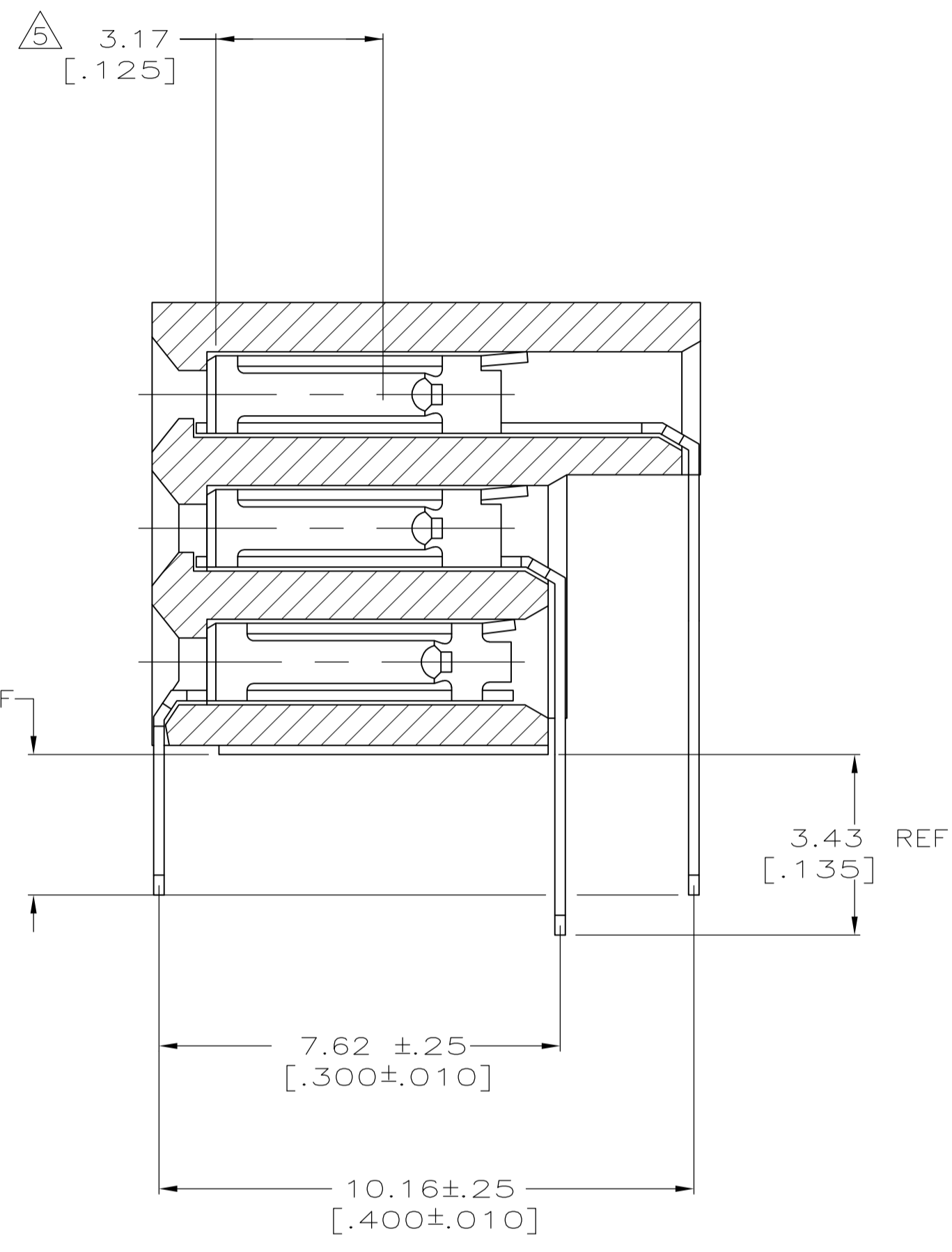

- ① HOUSING: POLYPHENYLENE SULFIDE GLASS FILLED.
- ② CONTACT: PHOS BRONZE
- ③ CONTACT: .00762[.000030] GOLD IN CONTACT AREA, .00127[.000050]-.00254[.000100] BRIGHT TIN-LEAD ON SOLDER LEADS, ALL OVER .00127[.000050] NICKEL
- ④ THESE DIMENSIONS PERTAIN TO CAVITY CENTERLINES (NOT TO CONTACT LOCATIONS)
- ⑤ POINT OF MEASUREMENT FOR PLATING THICKNESS (MEASURED INSIDE CONTACT BEAMS)
- ⑥ "AMP", "PART NUMBER", "DATE CODE", THE WORD "FRONT", AND "CSA" MARKED WITH .062 HIGH CHARACTERS. 21 POS. AND SMALLER FRONT IDENTIFIED WITH "↓". (ARROW)
- 7. CONTACTS SHALL MEET AN AVERAGE INSERTION FORCE OF 2.75 OZ. OR LESS AND A MIN WITHDRAWEL FORCE OF .50 OZ.
- ⑧ CONTACT: .00762[.000030] GOLD IN CONTACT AREA, .00127[.000050]-.00254[.000100] MATTE TIN ON SOLDER LEADS, ALL OVER .00127[.000050] NICKEL
- ⑨ ROHS 2002/95/EC COMPLIANT.
- ⑩ OBSOLETE PARTS: OBSOLETE CIS STREAMLINING PER D.RENAUD/D.SINISI

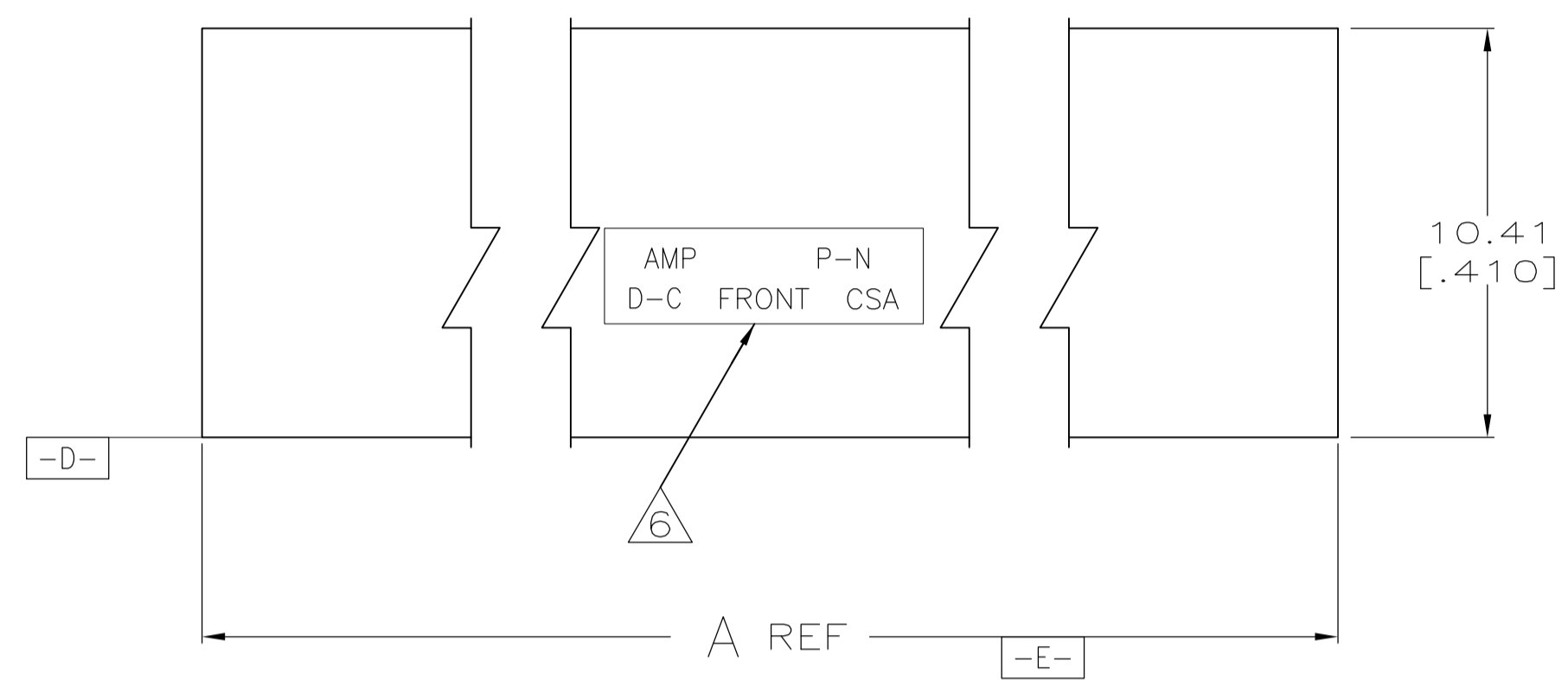
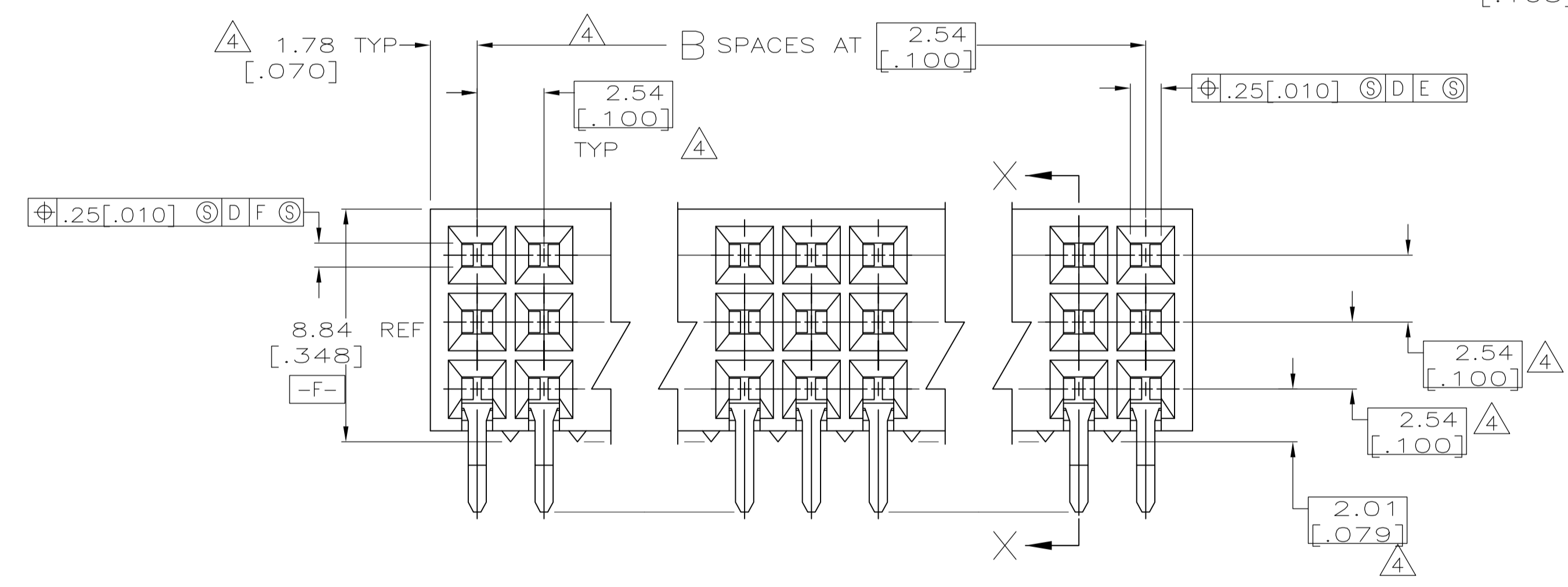

SECTION X-X
SCALE 10:1

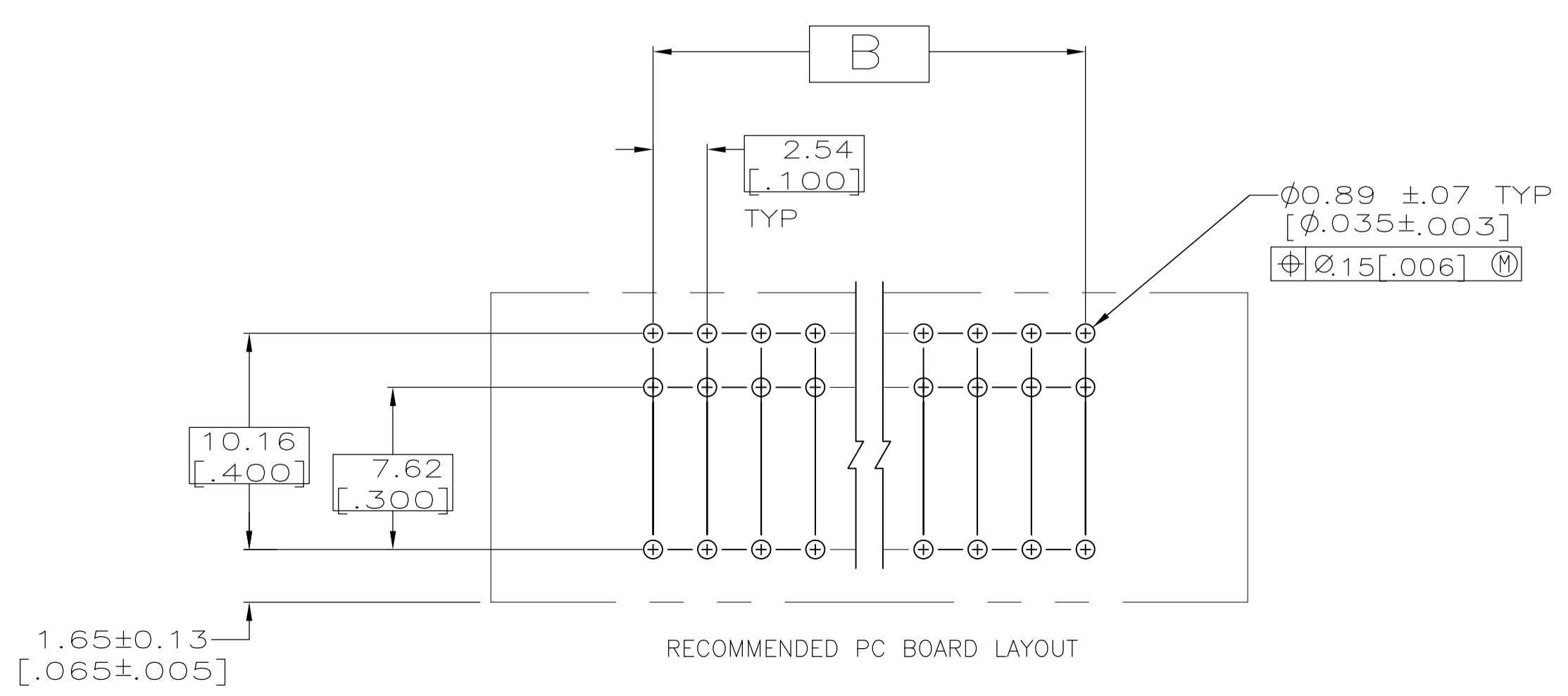

REV	DATE	BY	CHK	DESCRIPTION	DATE	DMN	APVD	
9	10			OBSOLETE	25	67.06 [2.640]	78	-5-535962-1-
					25	67.06 [2.640]	78	535962-1
				FINISH	B	A	NO OF POSN	PART NUMBER

THIS DRAWING IS A CONTROLLED DOCUMENT.

DIMENSIONS: INCHES	TOLERANCES UNLESS OTHERWISE SPECIFIED:	DWG	DATE	REV	DATE
0. PLC ± -	1. PLC ± -	KATE HELM	04/04/90		
2. PLC ± -	3. PLC ± .127(.005)	DOUG SARVER	04/04/90		
4. PLC ± -	ANGLES ± -				

THIS DRAWING IS A CONTROLLED DOCUMENT. DIM: KATE HELM 04/04/90. CHK: DOUG SARVER 04/04/90. APVD: - NAME: Tyco Electronics Corporation Harrisburg, PA 17105-3608. PRODUCT SPEC: RCPT ASSY, MOD II, 3 ROW CLOSED ENTRY, LOW FORCE. APPLICATION SPEC: - SIZE: A1. CAGE CODE: 00779. DRAWING NO: 535962. WEIGHT: - RESTRICTED TO: - MATERIAL: ① ② SEE TABLE. FINISH: - WEIGHT: - A1 00779 535962. CUSTOMER DRAWING. SCALE: 6:1. SHEET: 1 OF 1. REV: F2.