

THIS IS A CONTROLLED DOCUMENT.

RELEASED FOR PUBLICATION 11 BY AMP INCORPORATED. ALL RIGHTS RESERVED.

THIS DRAWING IS UNPUBLISHED COPYRIGHT 1989

DIMENSIONS

PRINT

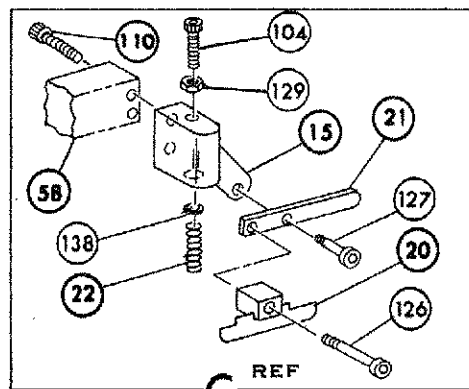
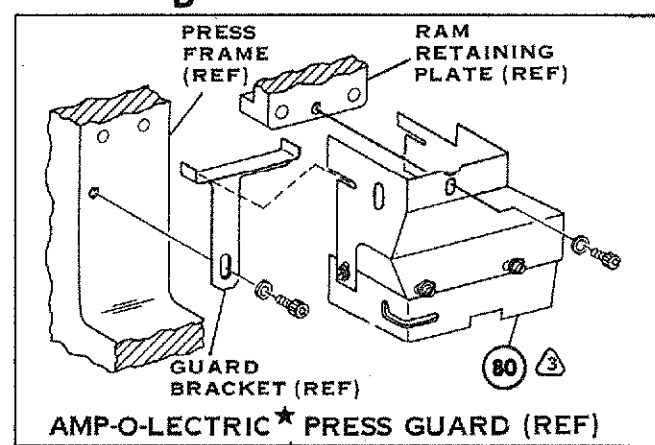
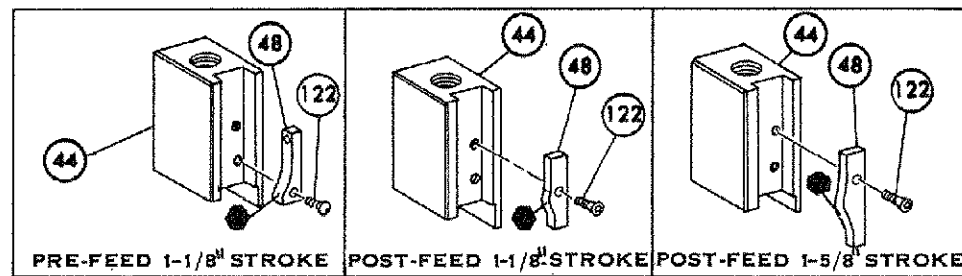
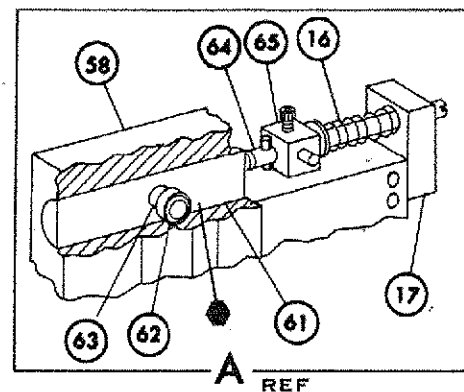

ALTERNATE DRAG METHOD

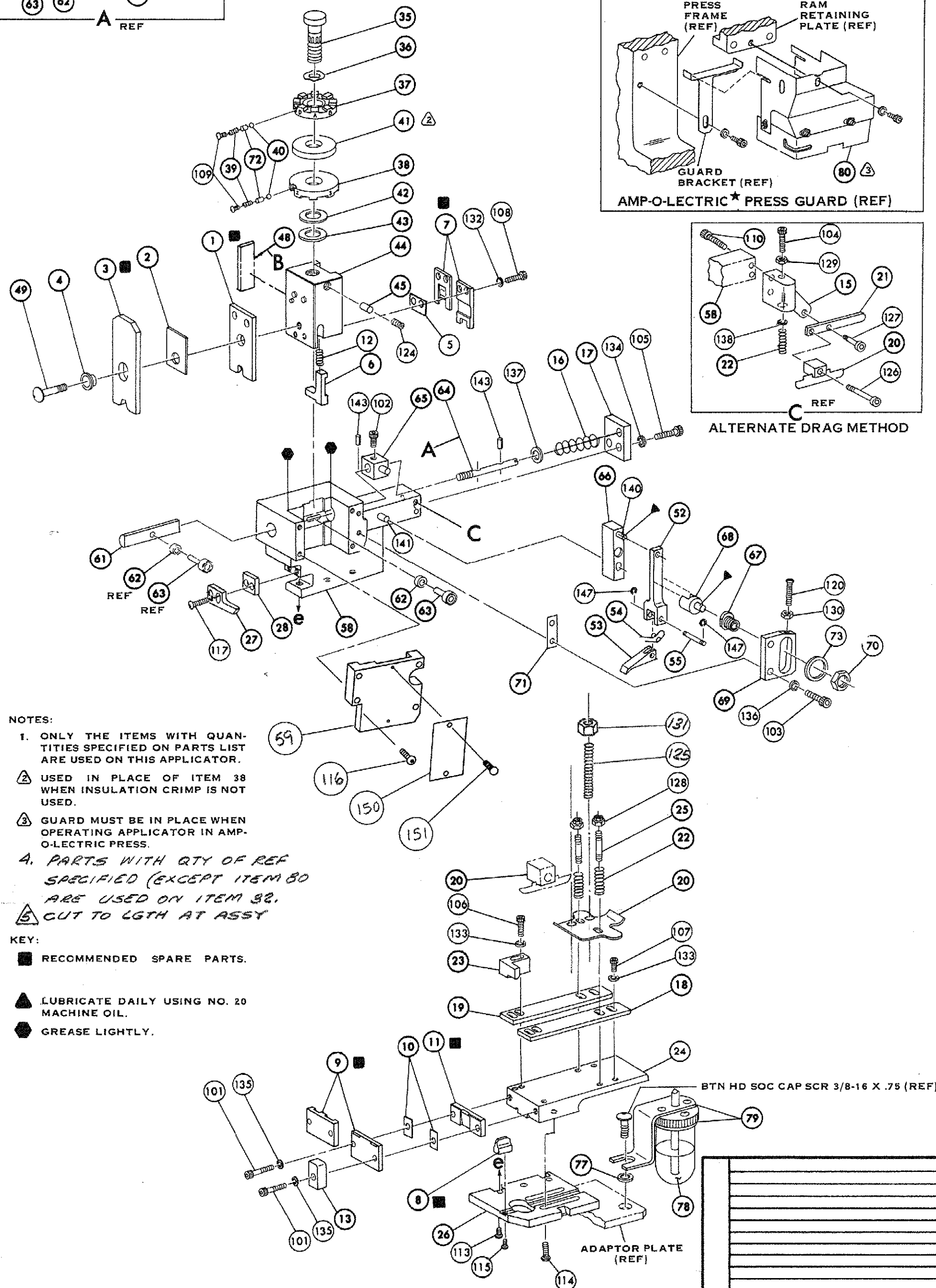

NOTES:

1. ONLY THE ITEMS WITH QUANTITIES SPECIFIED ON PARTS LIST ARE USED ON THIS APPLICATOR.
- ⊕ USED IN PLACE OF ITEM 38 WHEN INSULATION CRIMP IS NOT USED.
- ⊕ GUARD MUST BE IN PLACE WHEN OPERATING APPLICATOR IN AMP-O-LECTRIC PRESS.
- A. PARTS WITH QTY OF REF SPECIFIED (EXCEPT ITEM 80 ARE USED ON ITEM 32.
- ⊕ CUT TO LGTH AT ASSY

KEY:

- RECOMMENDED SPARE PARTS.
- ▲ LUBRICATE DAILY USING NO. 20 MACHINE OIL.
- GREASE LIGHTLY.

*TRADEMARK OF AMP INCORPORATED

REF	QTY	PART NO.	DESCRIPTION	NO.	REF	QTY	PART NO.	DESCRIPTION	NO.
		162	REF	690517-1	SPACER				71
		161	↑	22594-8	HEX, NUT				70
		160		240628-1	PLATE, ADJ				69
		159		240626-1	SHAFT, PIVOT				68
		158		240633-1	BUSHING				67
		157		455680-1	LEVER, INTERMEDIATE				66
		156		240629-1	BLOCK, PIVOT				65
		155		240632-2	SCREW, ADJ				64
		154		240659-3	PIN, CAM ROLLER				63
		153		240658-1	CAM, ROLLER				62
		152	REF	454398-1	ROD, FEED				61
		151							60
		150	REF	454220-1	CAP, RAM				59
		149	REF	453736-1	HOUSING				58
		148							57
		147							56
		146	REF	240624-1	PIN, FEED FINGER				55
		145	REF	691499-1	SPRING, FEED FINGER				54
		144	REF	240635-1	FINGER, FEED				53
		143	REF	240634-1	LEVER, TERMINAL				52
		142							51
		141							50
		140	1	7-21002-9	BOLT, CRIMPER				49
		139	1	690501-3	CAM, POSTFEED 1-1/8 STROKE				48
		138							47
		137							46
		136	1	690191-1	PLUG, NYLON				45
		135	1	455674-1	RAM				44
		134	1	690125-1	WASHER, LAMINATED				43
		133	1	690124-1	WASHER, RAM				42
		132							41
		131	2	23241-6	BALL, STEEL				40
		130	2	690170-1	SPRING, COMPRESSION				39
		129	1	690142-1	DISC, INSULATION				38
		128	1	690692-7	DISC, WIRE				37
		127	1	22480-5	WASHER, SPRING				36
		126	1	690212-1	POST, RAM				35
		125							34
		124							33
		123	1	458980-1	APPLICATOR, BASIC (SUB ASSY)				32
		122							31
		121							30
		120							29
		119	1	3-690451-2	SPACER, STRIPPER				28
		118	1	240639-1	STRIPPER				27
		117	REF	455676-1	PLATE, BASE				26
		116	2	22354-3	DRAG, STUD				25
		115	1	455678-1	PLATE, STRIP GUIDE				24
		114							23
		113	2	4-22281-1	SPRING, DRAG				22
		112							21
		111	1	454177-1	DRAG, STOCK				20
		110	1	458030-9	GUIDE, STRIP REAR				19
		109	1	458031-9	GUIDE, STRIP FRONT				18
		108	REF	454178-1	GUIDE, FEED ROD				17
		107	REF	4-22284-9	SPRING, FEED RETURN				16
		106							15
		105							14
		104							13
		103							12
		102	1	240644-1	PLATE, REAR SHEAR				11
		101	2	1-240645-0	SPACER, SHEAR PLATE				10
		80	1	240642-1	PLATE, FRONT SHEAR				9
		79	1	3-240655-7	ANVIL				8
		78	1	1-240651-6	BLADE, SLUG				7
		77							6
		76	1	3-240641-6	SPACER, SHEAR BLADE				5
		75	1	238009-1	SPACER, TUBULAR, INS CRIMPER				4
		74	1	1-456134-5	CRIMPER, INSULATION				3
		73	1	458888-3	SPACER, INSULATION				2
		72	1	1-456405-5	CRIMPER, WIRE				1

APPLICATOR CUT-OFF

CRIMPING DATA

PAD LETTER	CRIMP HEIGHT	WIRE SIZE	WIRE STRIP LENGTH	THIS APPLICATOR WILL APPLY
A	.055	#20		42156
B	.053	#22		42445
C	.050	#24		60123
D	.048	#26		60124
				60968
				61272
				61346

CRIMP	SIZE	TYPE	FEED	PRESS REF.
WIRE	.080	F		565435-5
INSULATION	.110	F	.650	

INSULATION RANGE: .048-.078 WIRE RANGE: 26-20 APPLICATOR INSTRUCTION: A8039

REMARKS: AMP-O-LECTRIC POST FEED

TERM APPL SPEC 114-2084

SET UP GAGE: 458638-1 LAYOUT NO.: 226

ECN 0150-6987-96

ECN 0150-0656-03

ECN 0150-7827-97

ECN 0150-6987-96

ECN 160488

REV. PER EOU 2-8823

APPROVED: [Signature]

CHECKED: [Signature]

SCALE: NONE NAME: [Blank]

MINIATURE QUICK CHANGE APPLICATOR

END-FEED (SPADE)

NO. 687962-2

LTR	REVISION RECORD	ECN	DATE	LTR	REVISION RECORD	ECN	DATE

LTR	REVISION RECORD	ECN	DATE	LTR	REVISION RECORD	ECN	DATE