

TOP VIEW

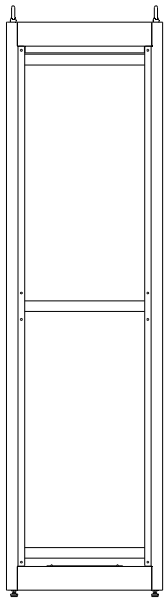

L.S. VIEW

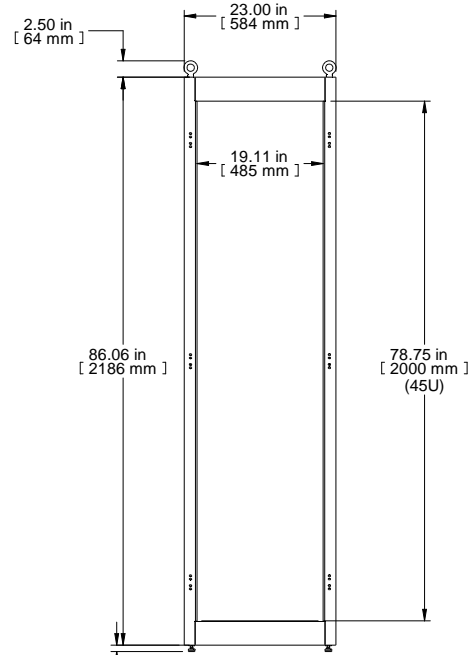

FRONT VIEW

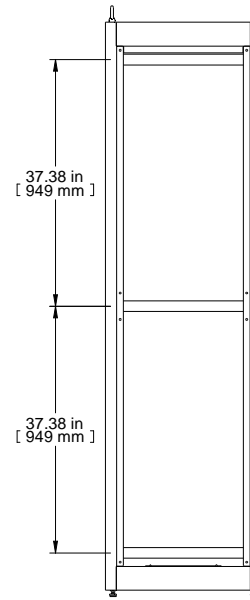

R.S. VIEW

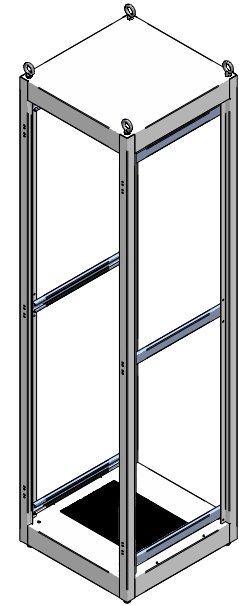

ISOMETRIC

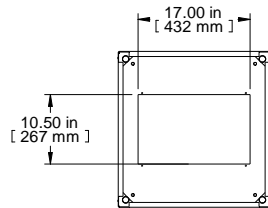

BOTTOM VIEW
BOTTOM OPENING

PART NUMBERS
C3F197823CG1 PAINTED CONTEMPRA GRAY TEXTURED

NOTES

Welded Assembly.
Bottom cover plate included.
See Hammond Website for Frame Accessories.

Français
Pour tous les détails sur nos produits, svp veuillez consulter
notre site www.hammondmfg.com

Data subject to change without notice. Isometric drawing not to scale.
Les données sont sujettes à changement sans préavis.

HAMMOND MANUFACTURING
www.hammondmfg.com
PART NO. C3F197823