

CRIMP DETAILS

- FOR STRIP LENGTH CONSIDER ESTABLISHED TECHNICAL CRIMP SPECIFICATION, FOR EXAMPLE IPC/WHMA-A-620.
- IN ADDITION KEEP CLEARANCE 'C' BETWEEN INSULATION AND CONTACT BARREL LESS THAN 50% OF OVERALL WIRE O.D., WITH A RECOMMENDATION OF MAX. 1MM CLEARANCE C.
- PUSH STRIPPED WIRES INTO TERMINAL UP TO STOP.
- AFTER CRIMPING CHECK IF STRIPPED WIRES ARE VISIBLE IN INSPECTION HOLE.

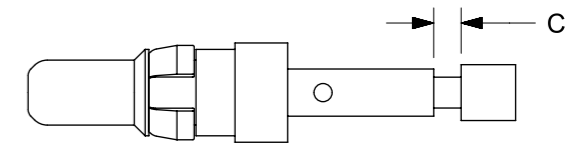
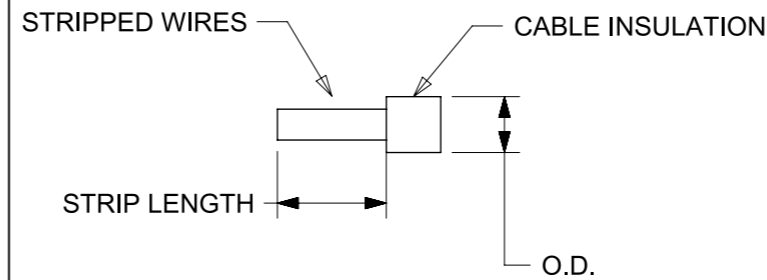

NOTES:

- 1.MATERIAL: COPPER ALLOY
- 2.PLATING-
MATING AREA: 0.1 μ m MIN. Au over 2 μ m MIN. NiP
TERMINATION AREA: 0.2 μ m MIN. Au over 2 μ m MIN. Ni
- 3.PRODUCT SPECIFICATION:
CIRCULAR CONNECTOR: 2009140003 PS
INLINE CONNECTOR: 2018400030 PS
- 4.APPLICATION SPECIFICATION: 200914003-AS (CIRCULAR CONNECTOR)
- 5.PACKAGING SPECIFICATION: 2018460001 PDD PK
- 6.MATES WITH THE TERMINAL SERIES 201846
- 7.USED WITH HOUSING SERIES 200914/201840
- 8.A)MAXIMUM ALLOWED OVERALL WIRE DIAMETER IS 6.50MM FOR SERIES 201840
B)MAXIMUM ALLOWED OVERALL WIRE DIAMETER IS 5.50MM FOR SERIES 200914
- 9.DIMENSIONS IN BRACKETS ARE REFERENCE ONLY.
- 10.CRIMPING TOOL DETAILS

FCT TOOLS

- HAND TOOL: M309
- PNEUMATIC CRIMP TOOL: WA27-309
- DIE: SP994
- SELECTOR NUMBER:
AWG 10/ SEL. 7
AWG 12/ SEL. 6

RoHS compliant by exemption 6(c)

QUALITY SYMBOLS	THIS DRAWING CONTAINS INFORMATION THAT IS PROPRIETARY TO MOLEX ELECTRONIC TECHNOLOGIES, LLC AND SHOULD NOT BE USED WITHOUT WRITTEN PERMISSION											
FA = 0	PRODUCTION RELEASE EC NO: 111695 DRWN: MRAMAKRISHNA CHK'D: ISHWARG REV APPR: ISHWARG	2016/12/19	2016/12/20	GENERAL TOLERANCES (UNLESS SPECIFIED)		DIMENSION UNITS	SCALE					
FE = 0				ANGULAR TOL ± °		MM	5:1					
FF = 0				4 PLACES ±	DRWN BY	DATE	MRAMAKRISHNA				2016/04/04	
▼ = 0				3 PLACES ±	CHK'D BY	DATE	MRAMAKRISHNA				2016/04/25	
▽ = 0				2 PLACES ± 0.13	APPR BY	DATE	ISHWARG				2016/12/13	
⊠ = 0	1 PLACE ± 0.25	DRAFT WHERE APPLICABLE MUST REMAIN WITHIN DIMENSIONS		DRAWING SIZE	THIRD ANGLE PROJECTION	PRODUCT CUSTOMER DRAWING						
■ = 0	0 PLACES ±	A3					SERIES	MATERIAL NUMBER	CUSTOMER			
▽ = 0	A1		REV		A3			201845	2018450030	GENERAL MARKET		
	A1		REV		A3			DOCUMENT NUMBER	DOC TYPE	DOC PART	SHEET NUMBER	
	A1		REV		A3			2018450030	PSD	000	1 OF 1	