

SECTION Z-Z

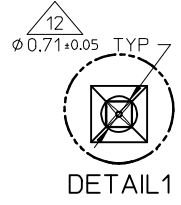
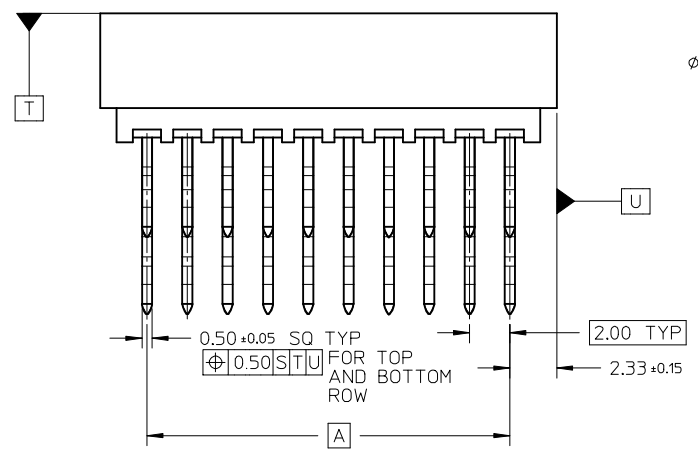

DWG REVISED	EC NO: S2017-0494	2017/03/22	2017/04/11	2017/04/12
DRW:WEANG	CHKD:CGOH	APPR:KHLIM		
REV	DESCRIPTION			
A1				

QUALITY SYMBOLS	$F_A = 0$	$F_C = 0$	$F_B = 0$
	$F_D = 0$	$F_E = 0$	$F_F = 0$
GENERAL TOLERANCES (UNLESS SPECIFIED)			
	mm	INCH	
4 PLACES	± ---	± ---	
3 PLACES	± ---	± ---	
2 PLACES	± 0.20	± ---	
1 PLACE	± ---	± ---	
0 PLACE	± ---	± ---	
ANGULAR ± 3 °			
DRAFT WHERE APPLICABLE MUST REMAIN WITHIN DIMENSIONS			

NOTES:

- FOR ILLUSTRATION PURPOSES, 20 CIRCUIT SIZE WAFER IS SHOWN.
- MATERIAL : HOUSING : LCP, UL94V-0, GLOW WIRE CAPABLE PER IEC-60335-1 5TH EDITION, GLASS FILLED. COLOR: BLACK. PIN : 0.50MM SQ. COPPER ALLOY.
- PRODUCT SPECIFICATION PS-151117-0001 APPLIES.
- RIB LOCATION VARIES, DEPENDING ON CIRCUIT SIZES.
- CKT 4 AND 6 HAS NO IDENTIFICATION TAG.
- REFER TO PACKAGING SPECIFICATION FOR TAPE & REEL : PK-151120-3000
- POSITION OF KAPTON TAPE TO BE LOCATED AT CENTER OF DIM A, IRRESPECTLESS OF CKT SIZES. TOP SURFACE OF KAPTON TAPE TO BE FLAT FOR PICK & PLACE PURPOSE.
- BEND DEPRESSION ON SMT TAIL IS ACCEPTABLE SO LONG AS IT DOES NOT AFFECT THE OVERALL COPLANARITY OF THE TAIL.
- CAVITY ID AND MX LOGO SHALL BE APPROXIMATELY AS SHOWN.

CKT SIZE	DIMENSION				
	A	B	C	D	E
4	2.00	4.85	6.65	5.00	---
6	4.00	6.85	8.65	7.00	---
8	6.00	8.85	10.65	9.00	---
10	8.00	10.85	12.65	11.00	---
12	10.00	12.85	14.65	13.00	---
14	12.00	14.85	16.65	15.00	8.00
16	14.00	16.85	18.65	17.00	10.00
18	16.00	18.85	20.65	19.00	12.00
20	18.00	20.85	22.65	21.00	14.00
22	20.00	22.85	24.65	23.00	16.00
24	22.00	24.85	26.65	25.00	18.00
26	24.00	26.85	28.65	27.00	20.00
28	26.00	28.85	30.65	29.00	22.00
30	28.00	30.85	32.65	31.00	24.00
32	30.00	32.85	34.65	33.00	26.00
34	32.00	34.85	36.65	35.00	28.00
36	34.00	36.85	38.65	37.00	30.00
38	36.00	38.85	40.65	39.00	32.00
40	38.00	40.85	42.65	41.00	34.00
42	40.00	42.85	44.65	43.00	36.00
44	42.00	44.85	46.65	45.00	38.00
46	44.00	46.85	48.65	47.00	40.00
48	46.00	48.85	50.65	49.00	42.00
50	48.00	50.85	52.65	51.00	44.00

DIMENSION STYLE	SCALE	DESIGN UNITS	THIRD ANGLE PROJECTION
MM ONLY	NTS	METRIC	
DRAWN BY	DATE	TITLE	
ATSEE	2015/03/06	ASSEMBLY MGRID, SHROUDED HEADER RIGHT ANGLE SMT	
CHECKED BY	DATE		
CGOH	2015/03/05		
APPROVED BY	DATE		
KHLIM	2015/11/05		
MATERIAL NO.	DOCUMENT NO.		SHEET NO.
SEE TABLE	SD-151120-0001		1 OF 2
THIS DRAWING CONTAINS INFORMATION THAT IS PROPRIETARY TO MOLEX INCORPORATED AND SHOULD NOT BE USED WITHOUT WRITTEN PERMISSION			

10 9 8 7 6 5 4 3 2 1

ASSEMBLY
151120 - X X X X

PLATING OPTIONS

-X0XX AND -X4XX	2.00µm MIN. TIN OVERALL 1.25µm MIN. NICKEL OVERALL
-X1XX AND -X5XX	0.05µm MIN. GOLD PLATE ON CONTACT AND 2.00µm MIN. TIN(MATTE) ON SOLDERTAIL OVER 1.25µm MIN. NICKEL OVERALL.
-X2XX AND -X6XX	0.38µm MIN. GOLD PLATE ON CONTACT AND 2.00µm MIN. TIN(MATTE) ON SOLDERTAIL OVER 1.25µm MIN. NICKEL OVERALL.
-X3XX AND -X7XX	0.75µm MIN. GOLD PLATE ON CONTACT AND 2.00µm MIN. TIN(MATTE) ON SOLDERTAIL OVER 1.25µm MIN. NICKEL OVERALL.

KAPTON TAPE IS USED FOR 4 - 12CKT ONLY

04 - 50 4CKT ~ 50CKT W/O PEG

PLATING		KAPTON VERSION
0	FULL TIN	WITHOUT KAPTON TAPE 14CKTS ~ 50CKTS
1	Au FLASH	
2	0.38 Au	
3	0.75 Au	WITH KAPTON TAPE 4CKTS ~12CKTS
4	FULL TIN	
5	Au FLASH	
6	0.38 Au	
7	0.75 Au	

PACKAGING	
0	TAPE & REEL

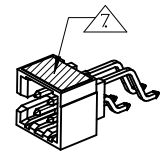
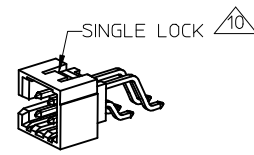
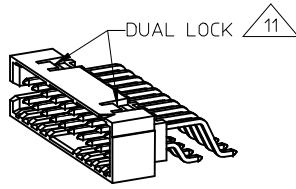

REFERENCE OF KAPTON TAPE PLACEMENT OF 4CKT

NOTES CONTINUE.

- SINGLE LOCK FEATURE FOR 4-12CKT.
- DUAL LOCK FEATURE FOR 14CKT AND ABOVE.
- DETAIL 1 FOR MMC REFERENCE ONLY.

DWG REVISED EC NO: S2017-0494 DRW: EANG CHKD: CGOH APPR: KHL IM	2017/03/22 2017/04/11 2017/04/12	DESCRIPTION QUALITY SYMBOLS $F_A=0$ $F_G=0$ $F_P=0$	GENERAL TOLERANCES (UNLESS SPECIFIED)		DIMENSION STYLE MM ONLY		SCALE NTS	DESIGN UNITS METRIC	THIRD ANGLE PROJECTION			
					mm	INCH	DRAWN BY ATSEE	DATE 2015/03/06	TITLE ASSEMBLY MGRID, SHROUDED HEADER RIGHT ANGLE SMT			
					4 PLACES	± ---	± ---	CHECKED BY CGOH	DATE 2015/03/05			
					3 PLACES	± ---	± ---	APPROVED BY KHL IM	DATE 2015/11/05			
A1	REV		DRAFT WHERE APPLICABLE MUST REMAIN WITHIN DIMENSIONS		SIZE A3		THIS DRAWING CONTAINS INFORMATION THAT IS PROPRIETARY TO MOLEX INCORPORATED AND SHOULD NOT BE USED WITHOUT WRITTEN PERMISSION					

9 8 7 6 5 4 3 2 1