



FCconnect.com

Copyright FCJ

1

2 3

4

5

6

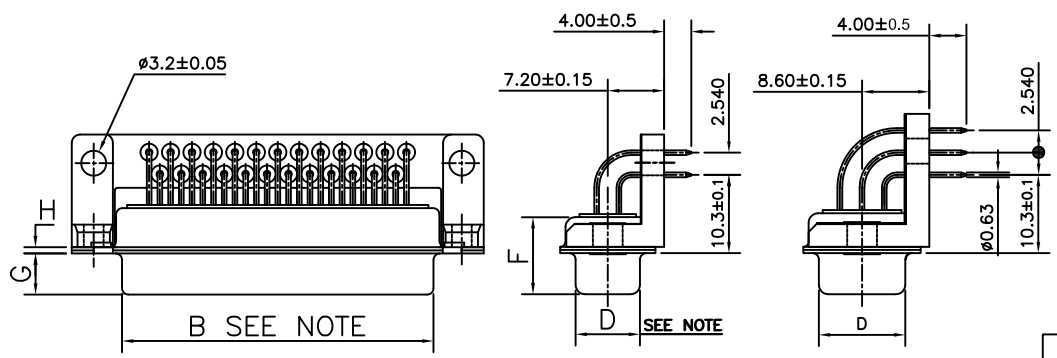

|            |   |              |              |            |              |              |       |              |              |
|------------|---|--------------|--------------|------------|--------------|--------------|-------|--------------|--------------|
| 50         | P | 66.65        | 52.68        | 61.11      | 11.08        | 14.99        | 11.09 | 5.85         | 1.0          |
|            | S | 66.65        | 52.30        | 61.11      | 10.62        | 14.99        | 11.21 | 6.05         | 0.8          |
| 37         | P | 68.94        | 55.30        | 63.50      | 8.23         | 12.17        | 11.09 | 5.85         | 1.0          |
|            | S | 68.94        | 54.71        | 63.50      | 7.77         | 12.17        | 11.21 | 6.05         | 0.8          |
| 25         | P | 52.65        | 38.84        | 47.04      | 8.23         | 12.17        | 11.09 | 5.85         | 0.8          |
|            | S | 52.65        | 38.25        | 47.04      | 7.77         | 12.17        | 11.21 | 6.05         | 0.8          |
| 15         | P | 38.76        | 25.12        | 33.32      | 8.23         | 12.17        | 10.99 | 5.85         | 0.8          |
|            | S | 38.76        | 24.54        | 33.32      | 7.77         | 12.17        | 11.21 | 6.05         | 0.8          |
| 09         | P | 30.43        | 16.79        | 24.99      | 8.23         | 12.17        | 10.99 | 5.85         | 0.8          |
|            | S | 30.43        | 16.21        | 24.99      | 7.77         | 12.17        | 11.21 | 6.05         | 0.8          |
| SHELL SIZE |   | +0.76<br>A-0 | +0.25<br>B-0 | ±0.12<br>C | +0.25<br>D-0 | +0.76<br>E-0 | F MAX | +0.15<br>G-0 | +0.22<br>H-0 |

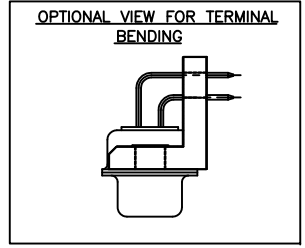

### TECHNICAL SPECIFICATIONS

|                             |   |  |
|-----------------------------|---|--|
| SHELLS                      | : | STEEL, TIN PLATED  |
| INSULATOR MATERIAL          | : | SELF EXTINGUISHING THERMOPLASTIC<br>UL CLASS 94 V0         |
| CONTACTS DIA ON ACTIVE AREA | : | ø1 MM.   |
| CONTACTS MATERIAL           | : | COPPER ALLOY   |
| CONTACT PLATING             | : | GOLD OVER NICKEL   |
| OPERATING TEMPERATURE       | : | -55°C +125°C   |
| OPERATING CURRENT           | : | 7.5 A PER CONTACT  |
| CONTACT RESISTANCE          | : | ≤7.3mΩ   |
| INSULATION RESISTANCE       | : | >5000 MΩ   |
| MAXIMUM VOLTAGE             | : | 1000 V.r.m.s   |
| MECHANICAL ENDURANCE        | : | 500 MATINGS  |
| DAMP HEAT                   | : | 21 DAYS FOR PLATING CODE 64<br>56 DAYS FOR PLATING CODE 65 |

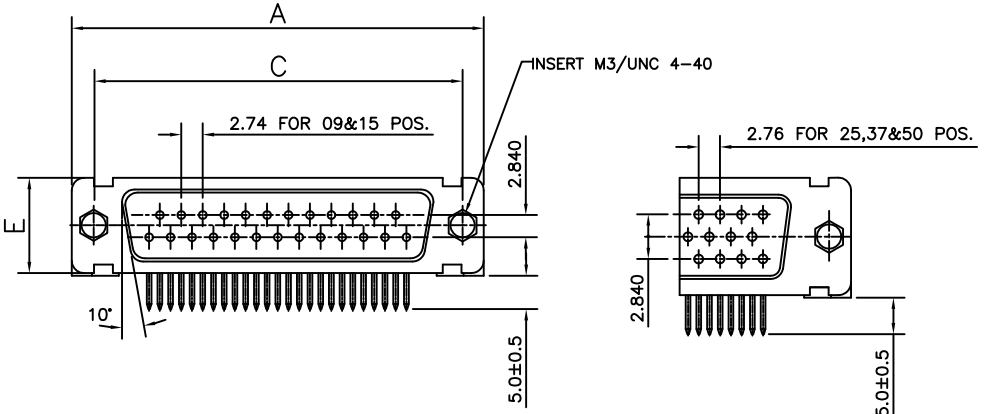

LAYOUT OF 50 POS.CONNECTOR

### ORDERING INFORMATION

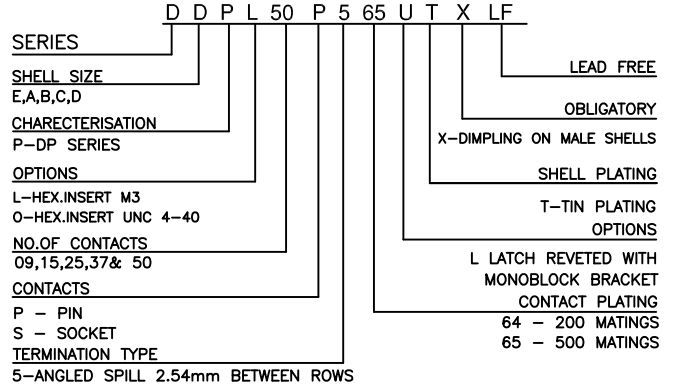

"This LF product meets European Union Directives and other country regulations as described in GS-47-0004."

The housing will withstand exposure to 260°C peak temperature for 3.5 seconds in a wave solder application with a 1.6mm minimum thick circuit board.

Packaging as per GS-14-920

- NOTES:
- 1) INSIDE DIMENSION OF MALE AND OUTSIDE DIMENSION OF THE FEMALE CONNECTOR
  - 2) REFER DRG: C-DSUB-0186 FOR PCB LAYOUT

|             |  |             |  |                  |  |            |  |                          |  |
|-------------|--|-------------|--|------------------|--|------------|--|--------------------------|--|
| mat'l. code |  | surface     |  | tolerance        |  | projection |  | product family           |  |
| -           |  | ISO 1302    |  | ISO 406 ISO 1101 |  | MM         |  | D-SUB                    |  |
| ltr         |  | ecn no      |  | dr               |  | date       |  | title                    |  |
| B           |  | 107-0025    |  | GVJ              |  | 2007/02/14 |  | MALE A/S CONNECTOR       |  |
| C           |  | ELX-I-20760 |  | MP               |  | 2015/05/02 |  | UT VERSION               |  |
| options     |  | angles      |  | linear           |  | scale      |  | dwg no                   |  |
|             |  | 0°±2'       |  |                  |  |            |  | sheet 1 of 1             |  |
|             |  | dr          |  | MINI K VANDANATH |  | 2003/01/24 |  | size                     |  |
|             |  | engr        |  | MITHUN PAUL      |  | 2015/05/02 |  | A3                       |  |
|             |  | chr         |  | ALIAS BABU       |  | 2015/05/02 |  | type                     |  |
|             |  | appd        |  | BIJU K PAUL      |  | 2015/05/02 |  | Product Customer Drawing |  |
| sheet index |  | revision    |  | C                |  |            |  |                          |  |
|             |  | sheet       |  | 1                |  |            |  |                          |  |