

THIS COPY IS PROVIDED ON A RESTRICTED BASIS AND IS NOT TO BE USED IN ANY WAY DETRIMENTAL TO THE INTERESTS OF PANDUIT CORP.

PANDUIT PART NO.	LENGTH	WEIGHT
WCM35DW8	96.00 ±.18 [ 2438 ±4.6 ]	1.17 LBS/96 IN [ 530.7 G/2438 MM ]

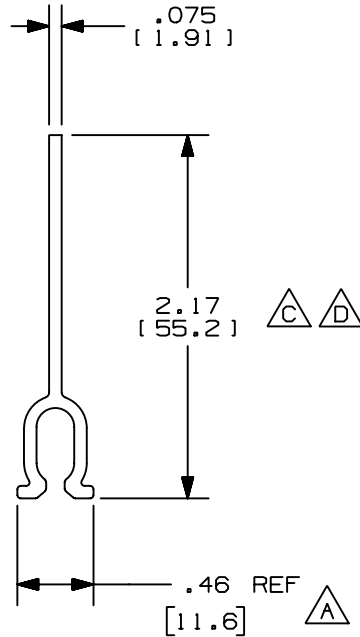

- NOTES:
- SEE CURRENT CATALOG FOR ADDITIONAL PART NUMBER SUFFIXES TO INDICATE COLOR AND/OR PACKAGE QUANTITY.
  - THIS PRODUCT IS INTENDED TO BE USED WITH PANDUIT TYPE WCM35 RACEWAY.
  - DIMENSIONS IN PARENTHESIS ARE IN METRIC.



CAD FILENAME/LAYERS D37786CG\_DC\_WCM35DW\_02A.PRT

PANDUIT CORP. TINLEY PARK, ILLINOIS  
**B** 3.5 INCH COVE MOLDING DIVIDER WALL (WCM35DW) CUSTOMER DRAWING

REV	DATE	BY	CHK	DESCRIPTION	ECN	CHK	CUST	SUP	DRAWN BY	MAT'L:	SCALE	DRAWING NO.	DWG SIZE
4	10-20-04	JBN	BKR	F. REVISED PART GEOMETRY	37786-15	RGRO	RGRO		JBN	PVC	NONE	37786-15	A
3	12-15-03	JBN	BKR	E. REVISED WEIGHT: WAS 1.08 LBS [ 490.0 G ] D. REVISED DIMENSION: WAS 2.18 [ 55.4 ]	37786-15	RGRO	RGRO		DATE 04-09-02				
2	11-14-02	JBN	BKR	C. REVISED DIMENSION: WAS 2.11 [ 53.6 ]	37786-15	RGRO	RGRO		CHK'D BKR				
-	-----	----	---	RELEASED TO PRODUCTION	-----	----	----						
1	11-04-02	JHEP	BKR	B. REVISED PART DESCRIPTION A. REVISED DIMENSION TO REFERENCE	37786-15	RGRO	RGRO						
R	04-09-02	JBN	BKR	DRAWING RELEASED									

UNLESS OTHERWISE SPECIFIED, DIMENSIONAL TOLERANCES ARE:  
 (.X)± (.XXX) ± .015 (.38)  
 (.XX)± .03 (.8) ANGLES ±

UNLESS OTHERWISE SPECIFIED, ALL DIMENSIONS ARE GIVEN IN INCHES, THIRD ANGLE PROJECTION.