

Flush-type connector - SACC-DSI-M5MS-3CON-L180 - 1530621

Please be informed that the data shown in this PDF Document is generated from our Online Catalog. Please find the complete data in the user's documentation. Our General Terms of Use for Downloads are valid (<http://download.phoenixcontact.com>)



Sensor/actuator flush-type plug, 3-pos., M5, prewall/screw mounting, with straight solder connection

Product description

Rear mounting, one-piece, for wave soldering processes, 180°



Key commercial data

| | |
|--------------------------------------|----------|
| Packing unit | 1 1 |
| Minimum order quantity | 20 1 |
| Weight per Piece (excluding packing) | 2.83 GRM |
| Custom tariff number | 85366990 |
| Country of origin | Germany |

Technical data

Ambient conditions

| | |
|---------------------------------|------------------|
| Ambient temperature (operation) | -25 °C ... 80 °C |
| Degree of protection | IP67 |

General

| | |
|------------------------|------------------------------|
| Rated current at 40°C | 1 A |
| Rated voltage | 60 V |
| Number of positions | 3 |
| Contact resistance | ≤ 3 mΩ |
| Insulation resistance | ≥ 100 MΩ |
| Coding | A - standard |
| Standards/regulations | M5 connector IEC 61076-2-105 |
| Status display | No |
| Surge voltage category | II |

Flush-type connector - SACC-DSI-M5MS-3CON-L180 - 1530621

Technical data

General

| | |
|-------------------|---|
| Pollution degree | 3 |
| Test voltage | 800 V |
| Connection method | Solder pins |
| Mounting type | Rear mounting M5 x 0.5 With locking nut |

Material

| | |
|---|---------------------|
| Inflammability class according to UL 94 | HB |
| Contact material | Cu alloy |
| Contact surface material | Au |
| Contact carrier material | PA 66 |
| Material, knurls | Nickel-plated brass |
| Sealing material | Viton |

Classifications

eCl@ss

| | |
|------------|----------|
| eCl@ss 4.0 | 27140815 |
| eCl@ss 4.1 | 27140815 |
| eCl@ss 5.0 | 27143423 |
| eCl@ss 5.1 | 27143423 |
| eCl@ss 6.0 | 27143423 |
| eCl@ss 7.0 | 27449001 |
| eCl@ss 8.0 | 27449001 |

ETIM

| | |
|----------|----------|
| ETIM 2.0 | EC001297 |
| ETIM 3.0 | EC002061 |
| ETIM 4.0 | EC002062 |
| ETIM 5.0 | EC002062 |

UNSPSC

| | |
|---------------|----------|
| UNSPSC 6.01 | 31251501 |
| UNSPSC 7.0901 | 31251501 |
| UNSPSC 11 | 31251501 |
| UNSPSC 12.01 | 31251501 |
| UNSPSC 13.2 | 31251501 |

Flush-type connector - SACC-DSI-M5MS-3CON-L180 - 1530621

Approvals

Approvals

Approvals

GOST

Ex Approvals

Approvals submitted

Approval details

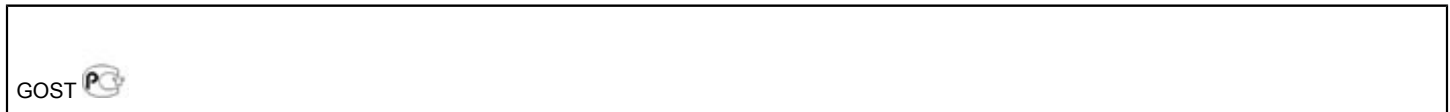

Drawings

Schematic diagram

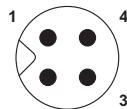

Pin assignment M5 plug, 3-pos., view male side

Dimensioned drawing

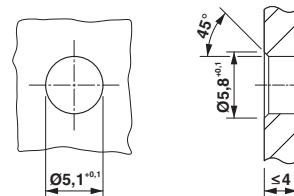

Drilling diagram

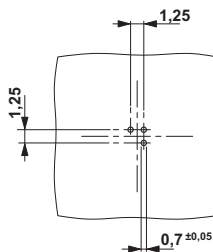

M5 flush-type plug

Dimensioned drawing

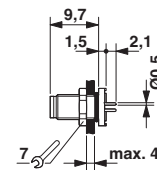

M5 flush-type plug

