

LOADING PATTERN MATING SIDE

f	0	0	0	0	0	0	0	0	0	0
e	4	4	4	4	4	4	4	5	4	4
d	4	4	4	4	4	4	4	5	4	4
c	5	5	5	5	5	5	5	5	5	5
b	4	4	4	4	4	4	4	5	4	4
a	4	4	4	4	4	4	4	5	4	4
z	0	0	0	0	0	0	0	0	0	0
P	0									
S	1	5								

LOADED CONNECTOR ASSEMBLY (FOR EXAMPLE)

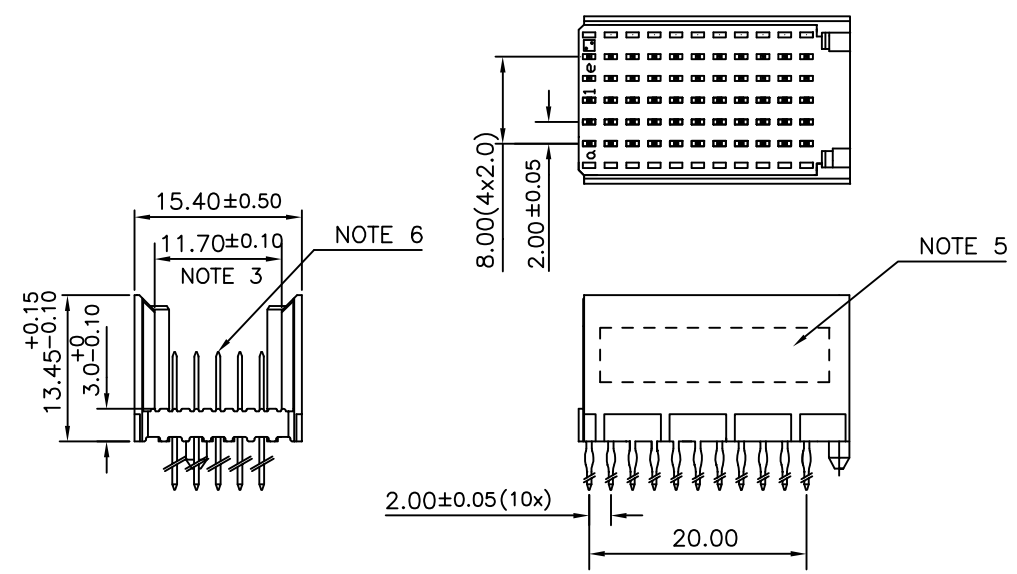

CONTACT OVERVIEW

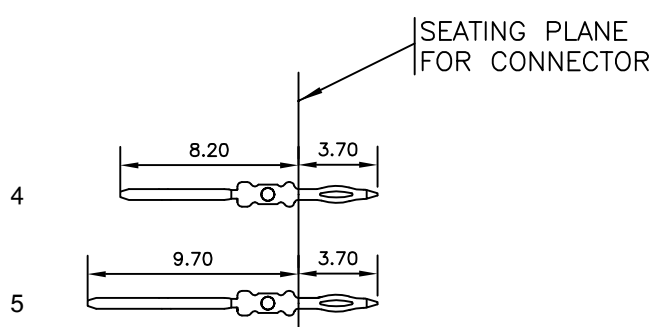

LAY-OUT P.C.B.-HOLE

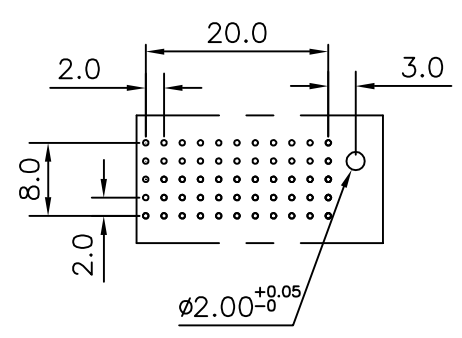

HM2P09PDP130 **LEAD FREE INDICATOR : LF = LEAD FREE (DIGIT 15 & 16)**  
**PLATING CODE (DIGIT 13 AND 14)**  
 (REF DRW NO. BS,C , 201844 , 003)

NOTES

- THIS PRODUCT IS CSA APPROVED.
  - THIS PRODUCT IS UL RECOGNIZED.
  - MEASURED AT THE BOTTOM.
  - MATERIAL CONTACT: PHOSPHORBRONZE  
HOUSING: CREAM WHITE GLASS FILLED POLYESTER UL-94V0
  - CONNECTOR PRINTED WITH P/N AND DATE CODE.
  - FOR ACTUAL CONTACT LOADINGS, SEE LOADING PATTERN MATING SIDE.
  - SHAPE OF CONNECTOR HOUSING CAN ALTER DEPENDING ON PRODUCTION LOCATION
  - THE PRODUCT (LF) MEETS EUROPEAN UNION DIRECTIVES AND OTHER COUNTRY REGULATIONS AS DESCRIBED IN GS-22-008
  - FOR RECOMMENDED PTH DIMENSIONS REFER DRAWING : BS, A , 201572 , 001
- CATALOG NO: HM2P09PDP130----

mat'l. code SEE NOTE 4				surface ISO 1302 ✓		tolerance ISO 406 ISO 1101		projection MM		product family MILLIPACS			
litr				ecn no		dr		date		title			
A				I05-0264		MINI		2005-12-02		MPACS 5+2R STR HDR PF CONN TYPE C			
B				I06-0141		MINI		2006-08-05					
				angles		linear		.0±0.2		scale -			
				0°±1°				.00±0.1					
				dr		MINI K VANDANATH		2005-12-02		FCI sheet 1 of 1 size 5 BS, C , 203028,634 A3			
				enr		BIJU K PAUL		2005-12-02					
				chr		BIJU K PAUL		2006-08-05		type Product Customer Drawing			
				appd		BIJU K PAUL		2006-08-05					
sheet index		revision sheet		B		1							